

# 2 X 2 HYDRAULIC THROUGH FRAME SLIDE-OUT COMPONENTS

## SLIDE-OUTS

**NOTE:** Part numbers are shown for identification purposes only. Not all parts are available for individual sale. All parts with a link to the Lippert Store can be purchased.

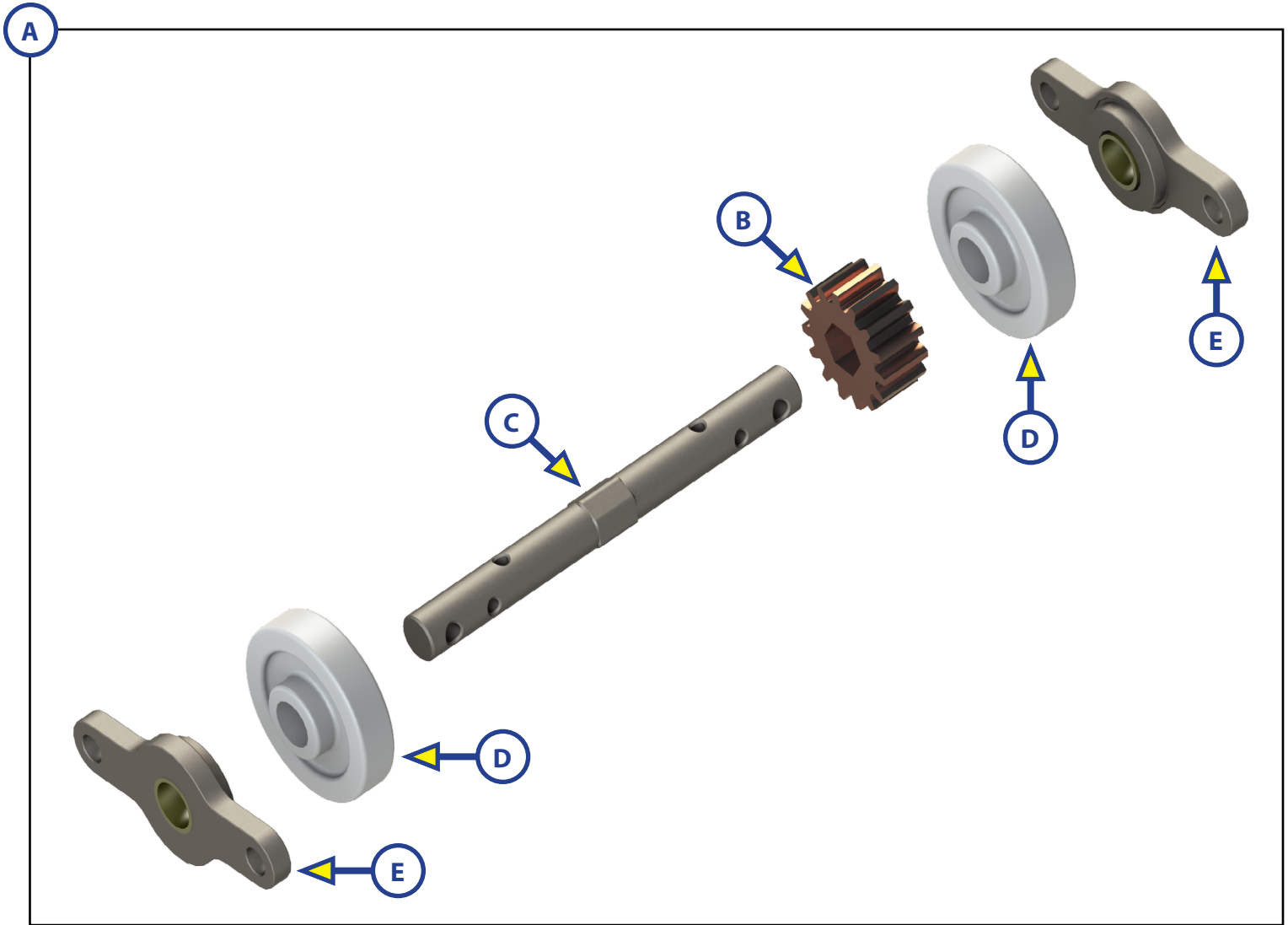

Callout	Part #	Description
Kit - A	<a href="#">281331</a>	2.5 X 2.5 Gear Pack
B	<a href="#">700612</a>	15 Tooth Gear (10DP/20PA)
C	<a href="#">271138</a>	Rod, 2 X 2 Drive Shaft
D	<a href="#">271137</a>	2 X 2 Gear Pack Roller - .625 X 2.365
E	<a href="#">372865</a>	Bearing Side Plate, Graphite - 4.000 X 1.641

# 2 X 2 HYDRAULIC THROUGH FRAME SLIDE-OUT COMPONENTS

## SLIDE-OUTS

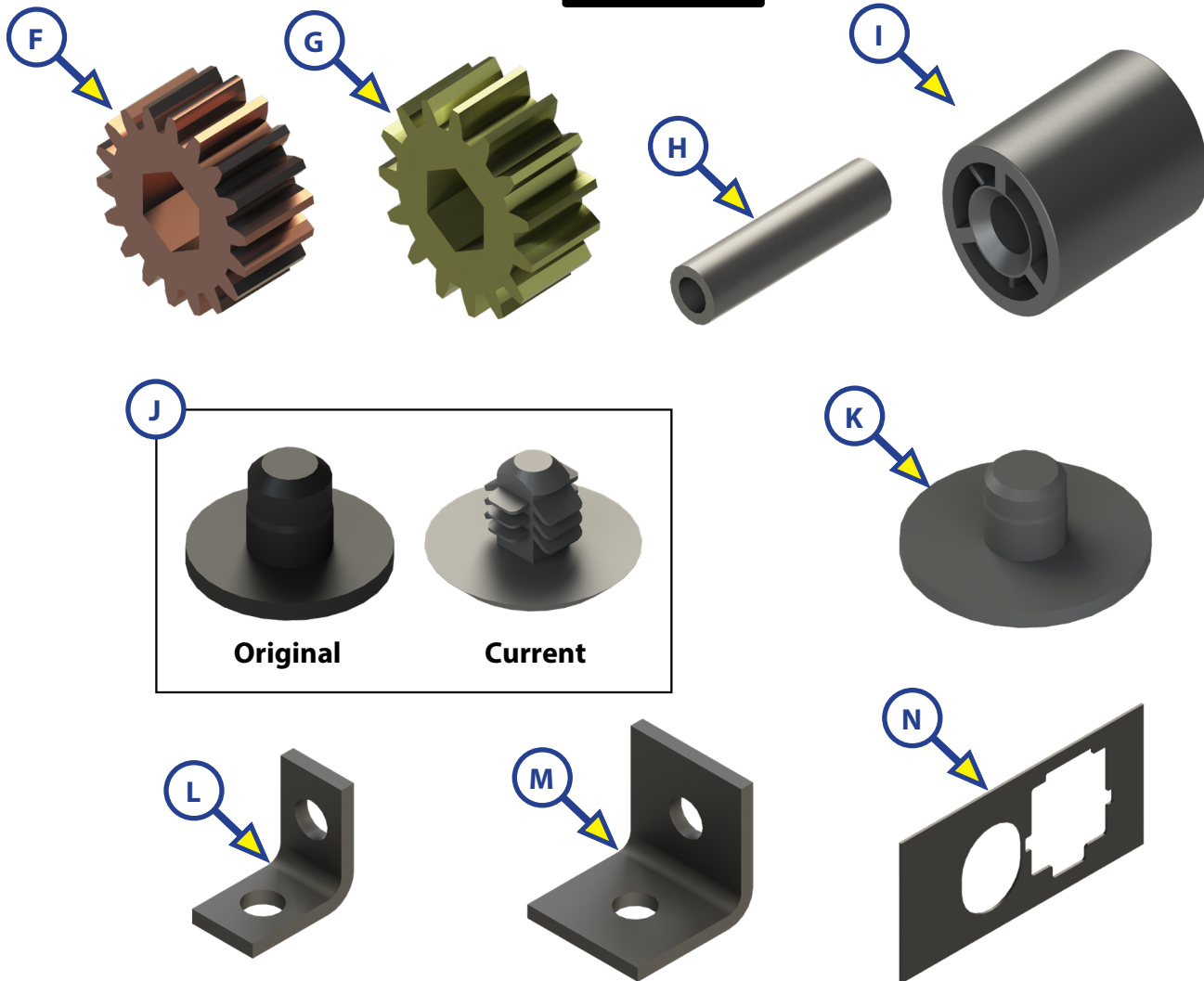

Callout	Part #	Description
F*	<a href="#">122739</a>	18 Tooth Gear (12 DP/ 14.50 PA)
G*	<a href="#">328044</a>	15 Tooth Gear (10DP/20PA), Heavy Duty
H	<a href="#">105892</a>	Rear Roller Shaft
I	<a href="#">104474</a>	Rear Roller
J	<a href="#">103480</a>	Wear Tab ( <b>Original</b> )
		Wear Tab ( <b>Current</b> )
K	<a href="#">277882</a>	Wear Tab (for 317322 Outboard Inner Arm)
L	<a href="#">113535</a>	Front Cylinder Bracket
M	<a href="#">106040</a>	Rear Cylinder Bracket
N	<a href="#">106030</a>	Trim Plate

**NOTE:** \*18 Tooth Gear may be used as a substitute for the 15 Tooth Gear in kits A where needed.

**NOTE:** \*Heavy duty gear is 15 tooth, and may be used as a substitute for the 15 Tooth Gear in kit A where needed.

# 2 X 2 HYDRAULIC THROUGH FRAME SLIDE-OUT COMPONENTS

## SLIDE-OUTS

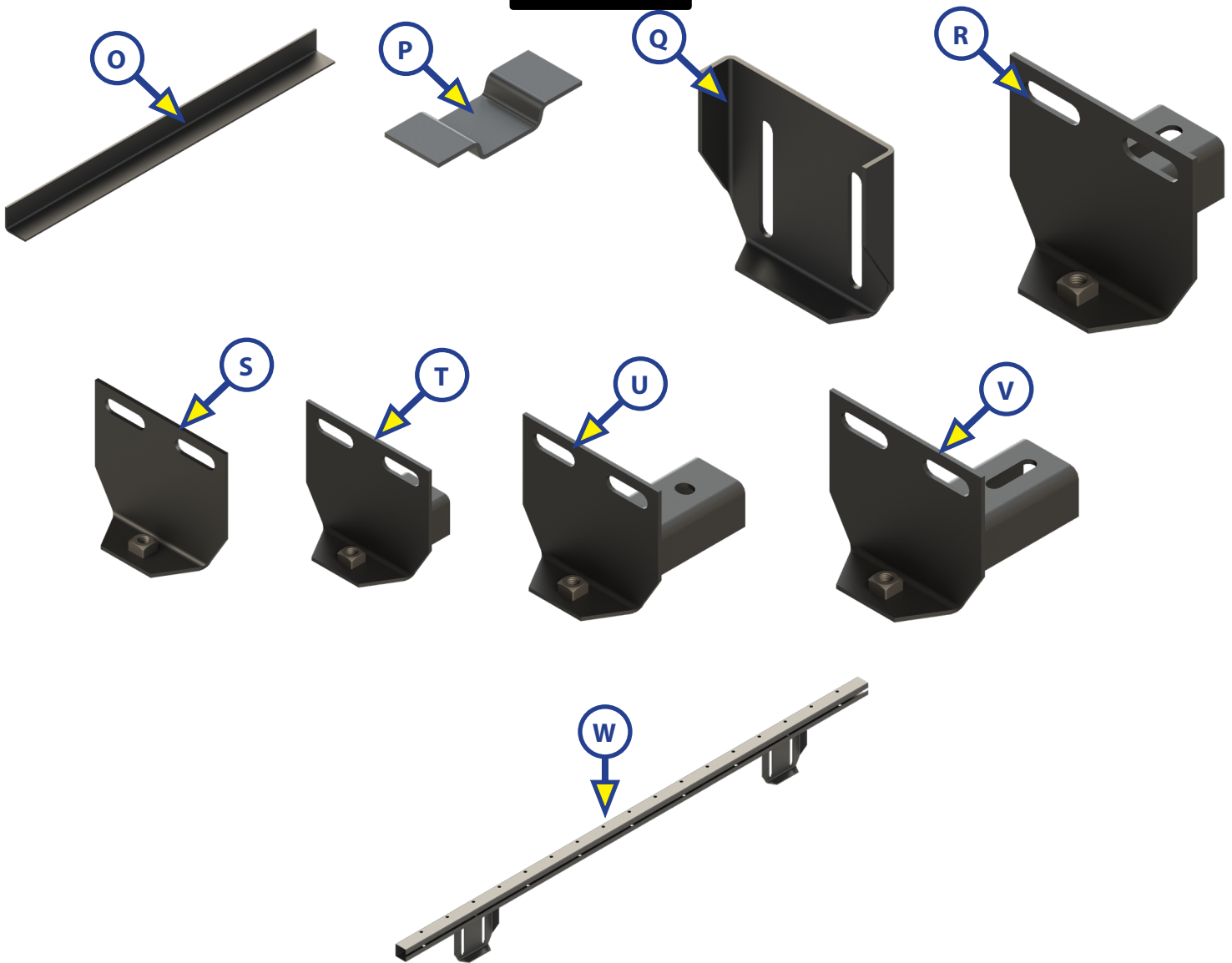

**NOTE:** See Room Bar Measurement Chart ([TI-052](#))

Callout	Part #	Description
O	<a href="#">102357</a>	Stiffener
P	<a href="#">106059</a>	Hat Channel
Q	<a href="#">104851</a>	Slide-Out Mounting Bracket
R	<a href="#">141792</a>	1 3/8" Adjustable Head Assembly
S	<a href="#">159624</a>	Standard Weld-On Head Assembly
T	<a href="#">163049</a>	Flush Adjustable Head Assembly
U	173593	Standard Flush Fixed Head Assembly
V	<a href="#">173594</a>	Standard Flush Adjustable Head Assembly
W	183949	Room Bar (Use for up to 80")
	183950	Room Bar (Use for up to 154")
<b>NOTE:</b> Brackets can be shipped loose.		

# 2 X 2 HYDRAULIC THROUGH FRAME SLIDE-OUT COMPONENTS

## SLIDE-OUTS

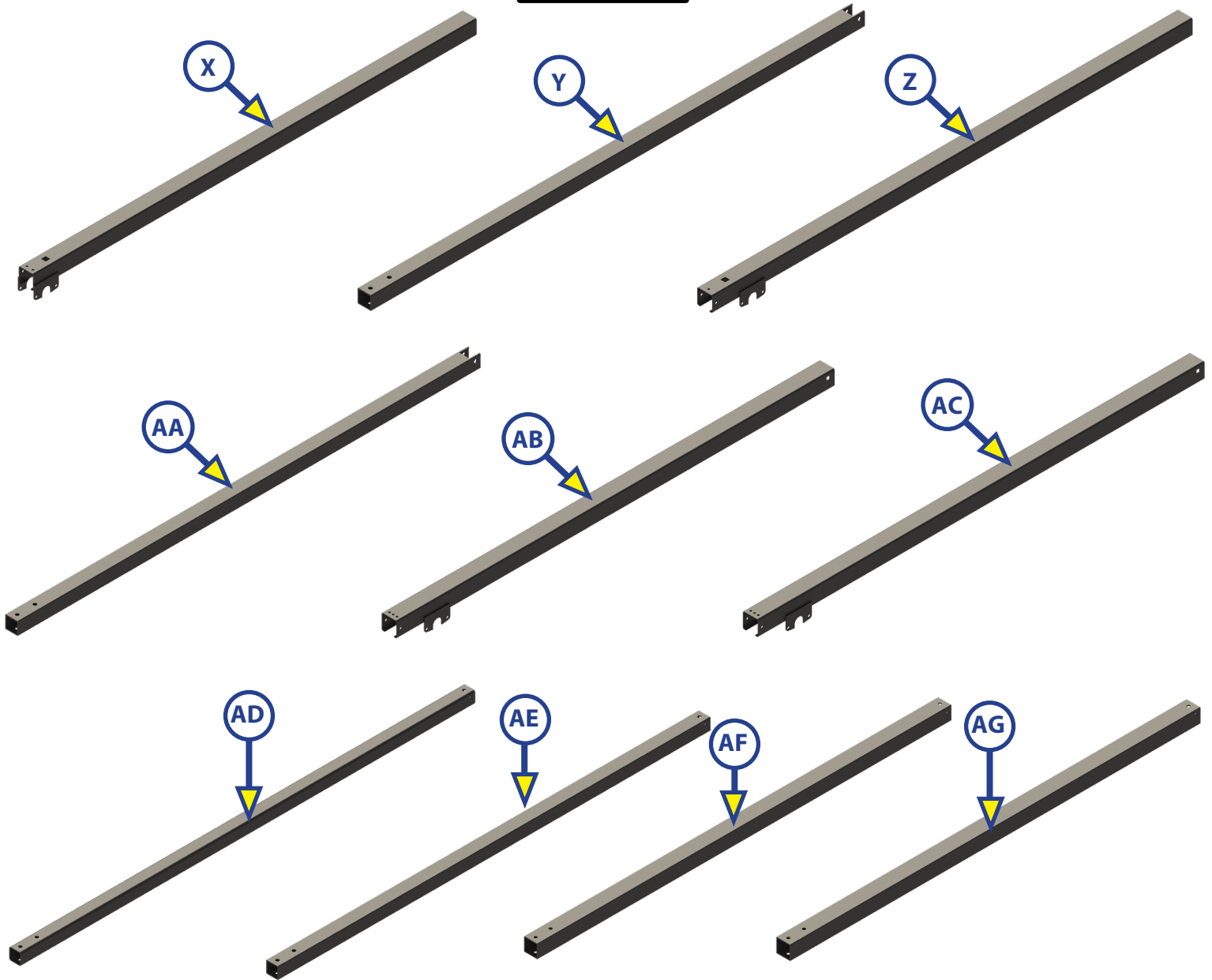

Callout	Part #	Description
X	<a href="#">145734</a>	Outboard Outer Arm (Idler and Drive)
Y	<a href="#">145736</a>	Outboard Inner Arm (15 Tooth)
Z	173204	Inboard Outer Arm 76" (Idler and Drive)
AA	<a href="#">163778</a>	Inboard Inner Arm (15 Tooth)
AB	161014	Inboard Outer Arm 69" (Idler and Drive)
AC	<a href="#">159389</a>	Inboard Outer Arm 70" (Idler and Drive)
AD	<a href="#">301393</a>	Inboard Inner Arm (15 Tooth)
AE	<a href="#">296090</a>	Outboard Inner Arm (15 Tooth)
AF	<a href="#">296121</a>	Inboard Inner Arm (15 Tooth, No Rear Roller)
AG	317322	Outboard Inner Arm (No Rear Roller) <b>OBSELETE</b>
<b>NOTE:</b> Standard slide-out arms have 15 teeth.		

# 2 X 2 HYDRAULIC THROUGH FRAME SLIDE-OUT COMPONENTS

## SLIDE-OUTS

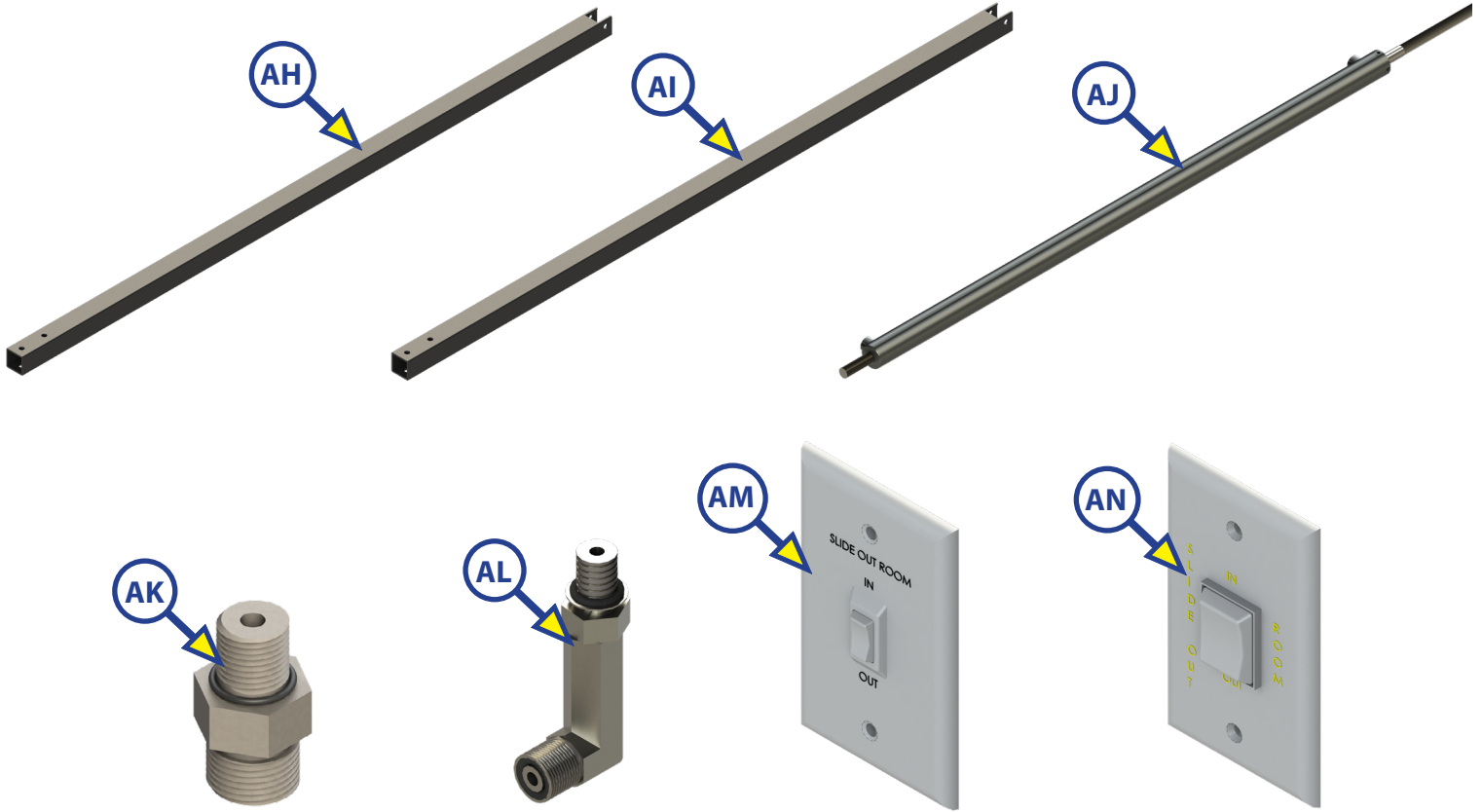

Callout	Part #	Description
AH	<a href="#">334649</a>	2 x 2 Outboard Inner Tube (18 Tooth)
AI	<a href="#">334650</a>	2 x 2 Inboard Inner Tube (18 Tooth)
AJ	<a href="#">354184</a>	Hydraulic Cylinder 43"
	<a href="#">342328</a>	Hydraulic Cylinder 38"
	<a href="#">354179</a>	Hydraulic Cylinder 30"
	<a href="#">339031</a>	Hydraulic Cylinder 24"
AK	<a href="#">141109</a>	O-Ring Face Seal Straight Fitting
AL	<a href="#">173738</a>	O-Ring Face Seal Elbow Fitting
AM	<a href="#">120639</a>	Hydraulic Interior Slide-Out Switch
AN	140530	6Prong Interior Switch with Wall Plate

# 2 X 2 HYDRAULIC THROUGH FRAME SLIDE-OUT COMPONENTS

## SLIDE-OUTS

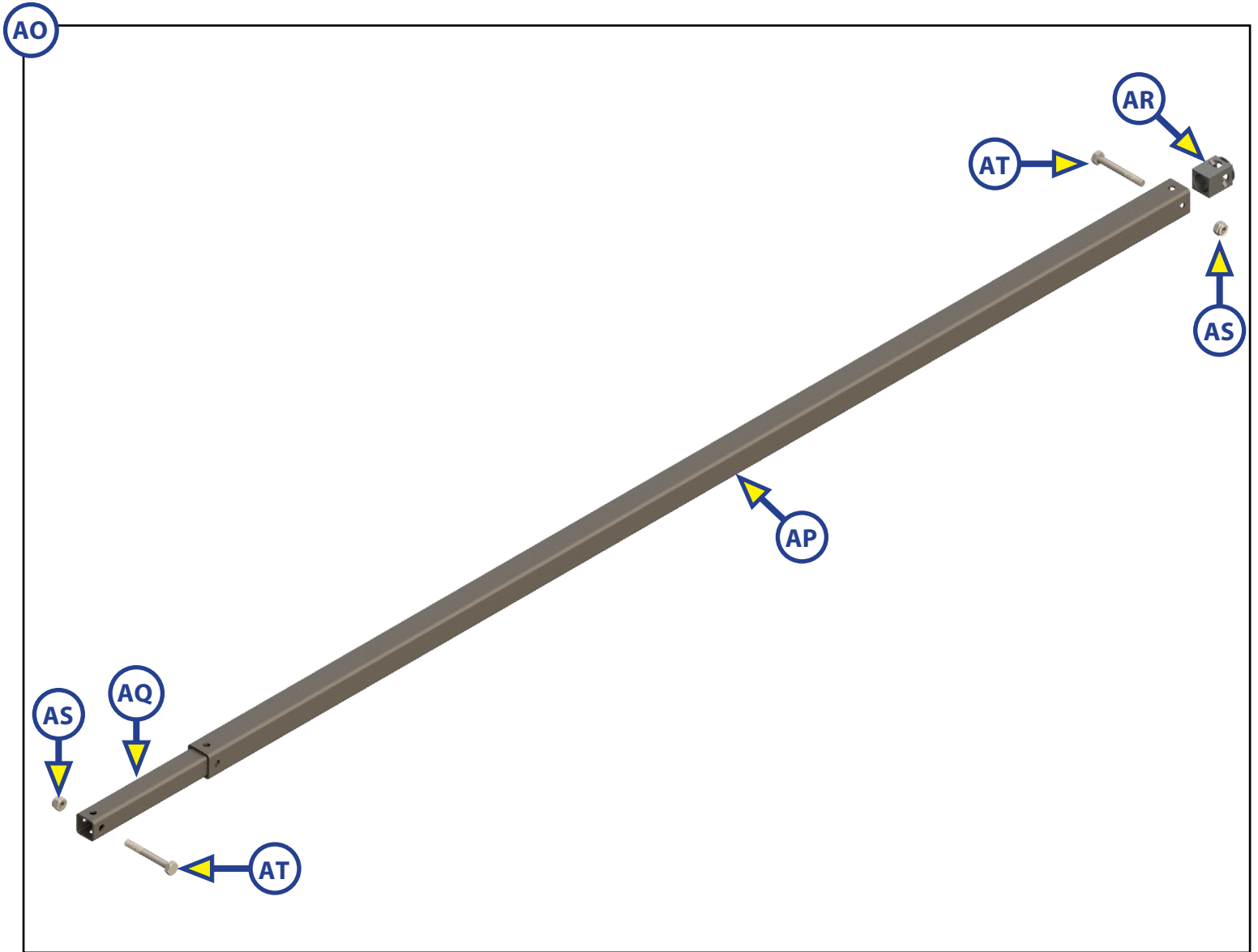

Callout	Part #	Description
Kit - AO	<a href="#">157523</a>	Slide-Out Cross Shaft Assembly
AP	<a href="#">117630</a>	Outer Cross Shaft
AQ	<a href="#">117606</a>	Inner Cross Shaft
AR	<a href="#">123365</a>	Cross Shaft Insert
AS	<a href="#">118092</a>	Nut, 1/4" - 20
AT	<a href="#">119066</a>	Bolt, 1/4" - 20 x 2"

# 2 X 2 HYDRAULIC THROUGH FRAME SLIDE-OUT COMPONENTS

## SLIDE-OUTS

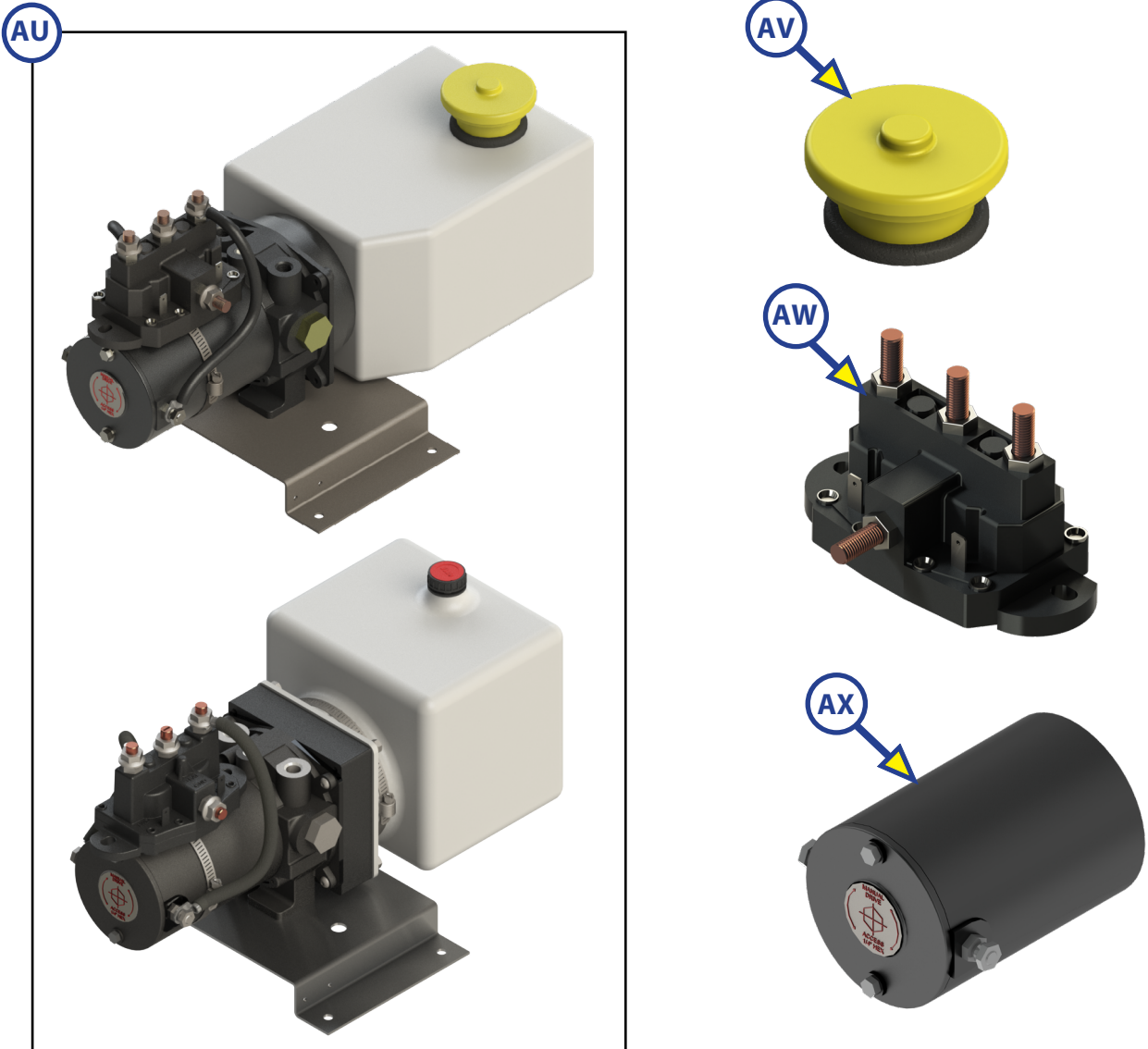

Callout	Part #	Description
AU*	<a href="#">141111</a>	Hydraulic Power Unit
AV	<a href="#">157505</a>	Yellow Fill Cap
AW	<a href="#">118246</a>	Dual Polarity Solenoid
AX	<a href="#">167576</a>	Power Unit Motor

**NOTE:** \*Hydraulic Power unit may appear as either example displayed above. Function and reservoir capacity are identical for each variation.