17" GRIDDLE/GRILL COMBO WITH STEEL PORCELAIN COOKING PLATE 15,000 BTU

MODEL (LIPPERT PN)

BC1715A (2022302019)

TROUBLESHOOTING AND SERVICE MANUAL



* Picture shown here is for reference only.

TABLE OF CONTENTS

Introduction	2
Safety	2
Important Safety Instructions	3
Codes	3
Precautions	3
Important Warnings	4
Installation Safety Precautions	4
Cleaning and Maintenance	4
To Clean Burner	4
Replaceable Parts List	5
Troubleshooting	6
Specifications	6

Introduction

This document provides an overview on replaceable parts for Furrion®/Greystone® 17" Griddle/Grill Combo with Steel Porcelain Cooking Plate, 15,000 BTU, as well as basic troubleshooting and service information.

Please keep this user manual in a safe place for future reference. This will ensure safe use and reduce the risk of injury. Be sure to pass on this manual to new owners of this product.

NOTE: Images used in this document are for reference only when assembling, installing and/or operating this product. Actual appearance of provided and/or purchased parts and assemblies may differ. For more detailed operation, including general safety instructions, warnings and cautions, see Instruction Manual at: https://lci-support-doc.s3.amazonaws.com/greystone_appliances/ccd-0007539.pdf or scan this QR code:



Safety

Read and understand all instructions before installing or operating this product. Adhere to all safety labels.

This manual provides general instructions. Many variables can change the circumstances of the instructions, i.e., the degree of difficulty, operation and ability of the individual performing the instructions. This manual cannot begin to plot out instructions for every possibility, but provides the general instructions, as necessary, for effectively interfacing with the device, product or system. Failure to correctly follow the provided instructions may result in death, serious personal injury, severe product and/or property damage, including voiding of the Lippert limited warranty.

WARNING

The "WARNING" symbol above is a sign that a procedure has a safety risk involved and may cause death or serious personal injury if not performed safely and within the parameters set forth in this manual.

WARNING

Failure to follow instructions provided in this manual may result in death, serious personal injury and/or severe product and property damage, including voiding of the component warranty.

CAUTION

The "CAUTION" symbol above is a sign that a safety risk is involved and may cause personal injury and/or product or property damage if not safely adhered to and within the parameters set forth in this manual.

CAUTION

Always wear eye protection when performing service, maintenance or installation procedures. Other safety equipment to consider would be hearing protection, gloves and possibly a full face shield, depending on the nature of the task.

Important Safety Instructions

DANGER

If you smell gas:

- Turn off gas to the appliance.
- Put out any open fire.
- If smell continues, walk away from the appliance and call your gas dealer or firemen at once.
- Don't leave this appliance unattended.
- Don't use this appliance within 25 ft to any flammable liquid.
- In the case of a fire, walk away from the appliance and call your firemen at once. Do not try to put out any oil or a grease fire with water.

NOTE: Not following these instructions may cause a fire or explosion which may cause property damage, personal injury, or death.

WARNING

Please read all necessary information for the proper assembly and safe use of the appliance before installing this equipment. If you have any problems, call your service team or supplier. Don't try to fix the problems yourself, or it will cause injury or property damage.

Codes

Installing this appliance must conform with state or other codes, or, in the absence of such codes, with either the National Fuel Gas Code, ANSI Z223.1 / NFPA 54, or the Standard for Recreational Vehicles, ANSI A/ NFPA 1192, and CSA Z240 RV Series, Recreational Vehicle Code, as applicable.

WARNING

California Proposition 65 Warning: The State of California is aware of this product can cause cancer and birth defects or other reproductive harm. (California law requires this warning be given to customers in the State of California.)

WARNING

Consumers must take responsibility to make sure the griddle is properly assembled, installed and maintained. Not following the instructions could result in life injury and/or property damage

Precautions

1. Don't use Griddles indoors it is intended for outdoors only.
2. Replace the exact model If the regulator supplied with the appliance fails to work, or call the customer service number
3. During any pressure test, the griddle and its individual shutoff valve must be disconnected from the gas supply piping system at test pressures in excess of 1/2 psi (3.5 kPa).
4. The appliance must be separated from the gas supply piping system through closing its individual manual shut-off valve during any pressure testing of the gas supply piping system at test pressures equal to or less than 1/2 psi (3.5 kPa).
5. Before using this appliance, visually inspect the gas hose from the tank connection to the orifice in case there is any wear, breaks, leaks, cracks, cuts or intrusions. If any of these are discovered, replace hose prior to operation.

6. Under the condition of rain, snow , hail, sleet, or other forms of precipitation while cooking with oil or grease, it is necessary that you must cover the cooking vessel at once and turn off the appliance burners and gas supply. Don't try to move the griddle or cooking vessel.
7. Make sure the appliance must be on a level, stable noncombustible surface in an area clear of combustible material during cooking. Don't place it on an asphalt surface (blacktop).

Important Warnings

- This griddle is used outdoors only, and can not be used in a building, garage, or any other enclosed area.
- It is not acceptable to be used on or under any flats or condominium balcony or deck.
- Using alcohol, prescription or non-prescription drugs may damage the consumer's ability to properly assemble or safely operate the griddle.
- A type BC or ABC fire extinguisher is necessary to be ready during cooking.
- When an oil or grease fire arise, don't attempt to extinguish with water. Must call the fire Department or use Type BC or ABC fire extinguisher.
- The appliance operation must be watched. Don't let children and pets near the appliance at all times.
- This appliance is not designed to be used as a heater and not suitable for frying turkeys.
- During and after use of the appliance, use insulated oven mitts or gloves for protection from hot surfaces or splatter from cooking liquids.
- Never put empty cooking vessel on the appliance while in operation. Be cautious when placing anything in cooking vessel while in operation.
- Never move the appliance during use. Must make sure the cooking vessel cool to 115°F (45°C) before moving or storing.
- NEVER use this appliance under extended awnings as it could cause a fire or personal injury. It is a correct way to install it on the opposite side from the fuel distribution/dispensing system of the recreational vehicle.
- To have a good storage (travel) position, ensure all low pressure propane gas system precautions are in place and all propane gas shut off valves are in the OFF position.

Installation Safety Precautions

- The installation must conform with local codes, or in the absence of local codes, with either the National Fuel Gas Code, ANSI Z223.1/ NFPA 54, Natural Gas and Propane Installation Code, CSA B149.1 or Propane Storage and Handling Code, B149.2, or the Standard for Recreational Vehicles, ANSI A 119.2/NFPA 1192, and CSA Z240 RV Series, Recreational Vehicle Code, as applicable.
- Don't use inside RV's or on boats.
- It is safely certified to be used in the countries of United States and Canada.
- Never modify and use in any other countries. Modification will cause a safety hazard or damage.

Make sure you have read and understand all safety information, warnings and precautions, then proceed to the next page for assembly & installation instructions according to your particular model.

Cleaning and Maintenance

To Clean Burner

Read the following instructions to clean the burner.

1. Shut the gas down at control knob.
2. All components must be cooled down.
3. Get griddle plate off from assembly.
4. Use wire to brush the entire outer surface of the burner to clean food residue and dirt.
5. A stiff wire such as an open paper clip can be used to clean any blocked ports.
6. Wear eye protection and use an air hose to force air into the burner tube and out the burner ports. Ensure each port to make sure air is coming out each respective nozzle.

Replaceable Parts List

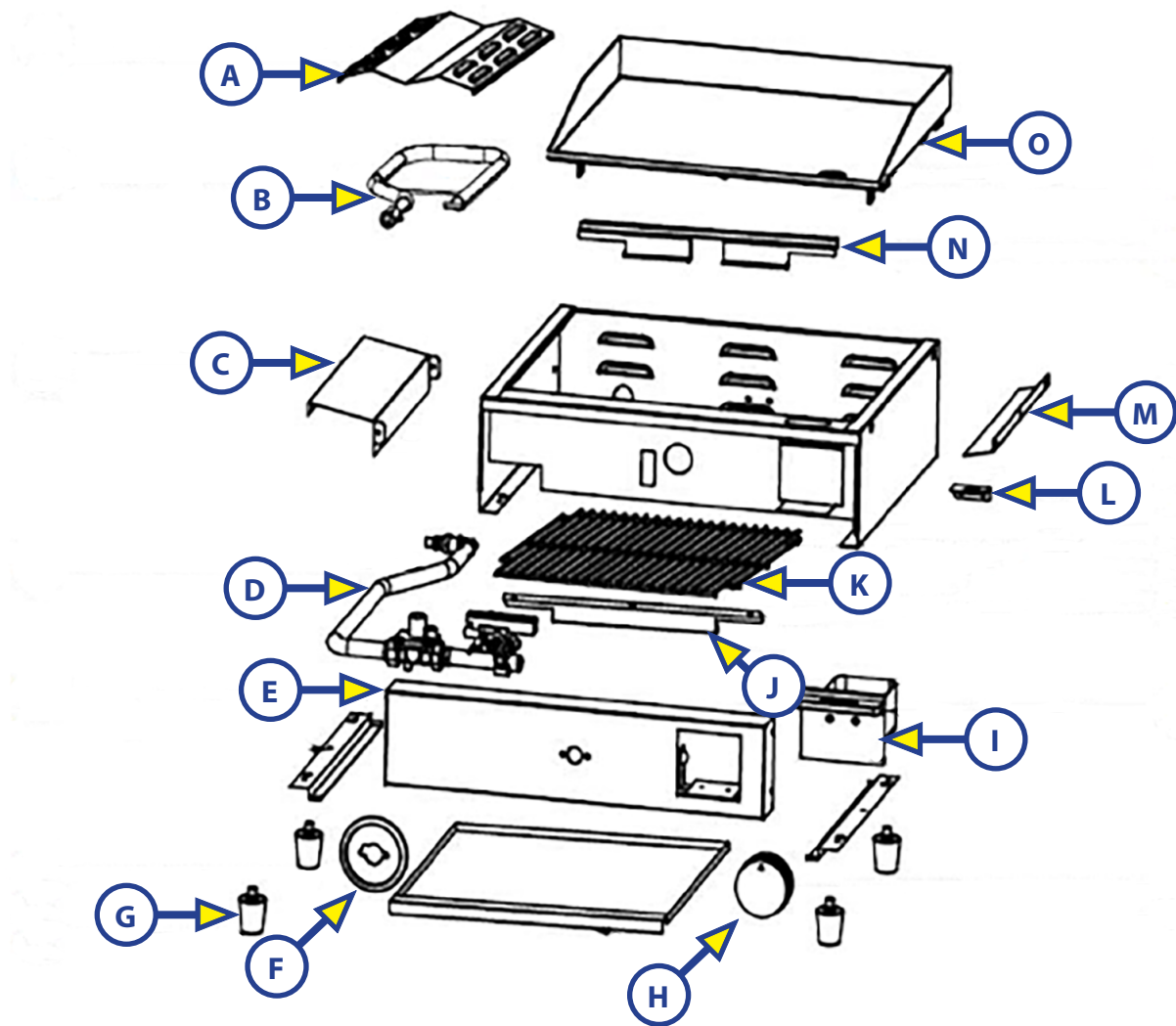

Callout	Part #	Description	Model
A	2023035402	Plate Against Wind	BC1715D
B	2023035403	Burner	BC1715D
C	2023035404	Thermal Insulation Plate (Glass Tube)	BC1715D
D	2023035405	Main Valve	BC1715D
E	2023035406	Control Panel	BC1715D
F	2023035407	Knob Base	BC1715D
G	2023035408	Support Base	BC1715D
H	2023035409	Knob	BC1715D
I	2023035410	Oil Container w/ Surface Panel and Handle	BC1715D
J	2023035411	Plate Against Wind Front Support	BC1715D
K	2023035412	Grill Mesh	BC1715D
L	2023035413	Burner Support	BC1715D
M	2023035414	Oil Guide Plate	BC1715D
N	2023035415	Plate Against Wind Front Support	BC1715D
O	2023035416	Frying Pan	BC1715D

Troubleshooting

Problem	Possible Cause	Solution
Using the piezoelectric ignition system can't light the burner	No Propane Supply or empty supply	Inspect shutoff valves Fill Propane supply.
	Defective regulator	Check regulator Call Customer Service.
	Electrode not in correct position or is Damaged/ Faulty	Ensure electrode is positioned as shown in "Ignition Electrode Position". Call Customer Service.
	Obstructions in gas injection or gas hose	Have injection and gas hose cleaned.
	Obstructions in the burner	Clean the burner following steps outlined in "Cleaning The Burner ".
A match can't light burner	No Propane Supply/ empty supply	Inspect shutoff valves Fill Propane supply.
	Defective regulator	Have regulator checked. Call Customer Service.
	Obstructions in gas injection or gas hose	Have injection and gas hose cleaned.
	Obstructions in the burner	Refer to "Cleaning The Burner " to clean the burner.
Burner has only low flame	Low inlet gas supply pressure	Check gas pressure on both inlet side and outlet side of appliance regulator. Call Customer Service.
	Low gas supply	Fill Propane Supply.
	Defective control valve	Call Customer Service.
Burner has a hissing or roaring noise	Obstructions in the burner	Refer to "Cleaning The Burner " to clean the burner.
	Obstructions in gas injection or gas hose	Have injection and gas hose cleaned.
	Burner could be damaged	Call Customer Service.

Specifications

Burner Input Rate	15000 BTU/h
Inlet Gas Pressure	10" WC to 13.8" WC
Unit Weight	30 lbs.



FURRION®

Furrion, LLC (Furrion) are wholly owned subsidiaries of Lippert Components, Inc. (Lippert)
Furrion, LLC (Furrion) sont des filiales en propriété exclusive de Lippert Components, Inc. (Lippert)
Furrion, LLC: 52567 Independence Ct., Elkhart, IN, 46514

Furrion Innovation Center & Institute of Technology
Centre d'innovation et institut de technologie Furrion
22244 Innovation Drive, Elkhart, IN 46514-5514, USA
Toll free/Numéro gratuit/Línea telefónica gratuita: 1-800-789-3341
Email/Courriel/Correo electrónico: customerservice@lci1.com

©2007-2025 Furrion, LLC. All rights reserved.
©2007-2025 Furrion, LLC. Tous droits réservés.

For Patent Info: www.Lippert.com/patents
Pour des informations sur les brevets: www.Lippert.com/patents

SUPPORT.LCI1.COM/FURRION



The contents of this manual are proprietary and copyright protected by Lippert. Lippert prohibits the copying or dissemination of portions of this manual unless prior written consent from an authorized Lippert representative has been provided. Any unauthorized use shall void any applicable warranty. The information contained in this manual is subject to change without notice and at the sole discretion of Lippert. Revised editions are available for free download from lippert.com.

Please recycle all obsolete materials.

Les renseignements contenus dans le présent manuel peuvent seulement être distribués sous forme de document complet, à moins de recevoir l'approbation explicite de Lippert Components pour distribuer des parties individuelles. Tous les renseignements contenus dans le présent manuel peuvent être modifiés sans préavis. Les éditions révisées pourront être téléchargées gratuitement sur le site lci1.com. Ces renseignements sont considérés comme étant factuels jusqu'à ce qu'une version révisée les rende désuets.

Veuillez recycler tout le matériel désuet.

For all concerns or questions, please contact Lippert.
Communiquer avec Lippert Components si vous avez des questions ou des préoccupations.
Ph: 432-LIPPERT (432-547-7378) | Web: lippert.com | Email: customerservice@lci1.com