



EUROLOFT™ BED LIFT
OWNER'S MANUAL

TABLE OF CONTENTS

| | |
|--|----------|
| Introduction | 2 |
| Safety Information | 3 |
| Important Safety Information | 3 |
| Operation | 4 |
| Prior to Operating the EuroLoft Bed Lift System | 4 |
| Lowering the Bed Lift | 4 |
| Raising the Bed Lift | 5 |
| Troubleshooting | 5 |
| Advanced Control System (ACS) Stop Setting Procedure | 5 |
| Manual Override | 6 |
| Maintenance | 6 |
| Notes | 7 |

Introduction

The EuroLoft™ Bed Lift distributed by Lippert Components, utilizes a unique nylon strap-based system, adaptable to a broad range of RV and heavy truck applications including cabs, living rooms, slide-out rooms and master bedrooms. The straps retract into the bed base, concealing the lifting system in the retracted position, permitting OEMs more floor plan design freedom. The nearly silent EuroLoft system is operated by a single motor that controls four support mounts to raise and lower the bed at 2.3 inches per second. The 800-pound capacity system can be customized in both size and configuration to maximize space in any motorhome, towable RV or truck cab floor plan design. The system can even “bend” to conform to wall curvatures found in some motorhome cabs.

Additional information about this product can be obtained from lci1.com/support or by downloading the free LippertNOW app. The app is available on Apple App Store® for iPhone® and iPad® and also on Google Play™ for Android™ users.

Apple App Store®, iPhone®, and iPad® are registered trademarks of Apple Inc.

Google Play™ and Android™ are trademarks of Google Inc.

For information on the assembly or individual components of this product, please visit:

<https://support.lci1.com/euroloft-bed-lift>

NOTE: Images used in this document are for reference only when assembling, installing and/or operating this product. Actual appearance of provided and/or purchased parts and assemblies may differ.

Safety Information

WARNING

Failure to act in accordance with the following instructions may result in death, serious injury or property damage.

WARNING

The "WARNING" symbol above is a sign that a procedure has a safety risk involved and may cause death or serious personal injury if not performed safely and within the parameters set forth in this manual.

WARNING

Failure to follow instructions provided in this manual may result in death, serious personal injury and/or severe product and property damage, including voiding of the component warranty.

CAUTION

The "CAUTION" symbol above is a sign that a safety risk is involved and may cause personal injury and/or product or property damage if not safely adhered to and within the parameters set forth in this manual.

CAUTION

Always wear eye protection when performing service, maintenance or installation procedures. Other safety equipment to consider would be hearing protection, gloves and possibly a full face shield, depending on the nature of the task.

CAUTION

Moving parts can pinch, crush or cut. Keep clear and use caution during assembly.

Important Safety Information

- Safety devices shall not be tampered with for any reason.
- It is strictly forbidden to be on the bed lifting system while it is being operated.
- Do not interfere with the bed lifting system while operated, neither with any objects or with hands.
- Before starting the vehicle engine and driving, always make sure the bed lifting system is in its highest position and the safety belts are fastened (excluding garage bed).
- Do not operate the system improperly (e.g. with people on it).
- The bed lifting system shall only be used by adults and responsible staff.
- It is forbidden to use the bed lifting system while the vehicle is running.
- Do not move the bed lifting system if people or animals or items are around, under or on it.
- The bed lifting system must never be used while the vehicle is running.
- It is forbidden to start the bed lift system manually with disconnected wires from motor unit to control unit.
- Should the mechanism not work, do not use the bed and ask for assistance at the next service center.

NOTE: Always install the bed lifting system taking into account the system maximum load. The bed unit, as a whole - Including bed lifting system, mattress, pillow, blankets, etc. - must not weigh more than 132 lbs.

NOTE: The bed lifting system can bear a total maximum weight of 800 lbs.

Operation

⚠ WARNING

Always make sure that the EuroLoft Bed Lift path is clear of people, pets and objects before and during operation. Always keep away from the slide rails when the bed is being operated.

Prior to Operating the EuroLoft Bed Lift System

⚠ WARNING

The bed lifting system must never be used while the vehicle is in motion.

1. Make sure the vehicle is parked, secured and stabilized before starting bed lift operations.
2. Set the parking brake, if applicable.

Lowering the Bed Lift

1. Make sure the safety belts are unfastened.
2. Turn the key switch to the ON position (Fig. 1D) located on the key pad.
3. Press and hold the DOWN arrow-shaped button (Fig. 1B) on the key pad. A green LED light (Fig. 1C) on the key pad will turn on in the direction the bed is moving. The bed will keep moving until it reaches the pre-set stop position.

NOTE: The bed will stop moving when the button is released. Continue to press and hold the button until the stop position has been reached.

4. Release the DOWN arrow-shaped button.
5. Turn the key to the OFF position.

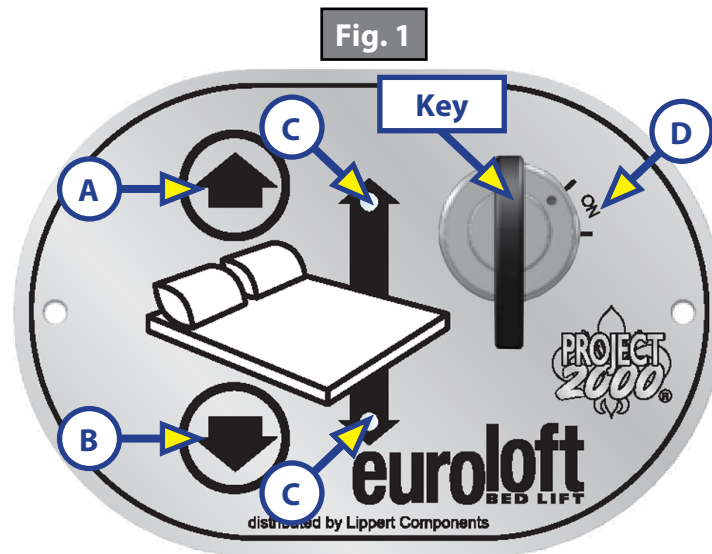

Raising the Bed Lift

1. Turn the key switch to the ON position (Fig. 1D) located on the key pad.
2. Press and hold the UP arrow-shaped switch (Fig. 1A) on the key pad. A green LED light (Fig. 1C) on the key pad will turn on in the direction the bed is moving. The bed lift will keep moving until it reaches the pre-set stop position.

NOTE: The bed will stop moving when the button is released. Continue to press and hold the button until the stop position has been reached.

3. Release the UP arrow-shaped button.
4. Make sure safety belts are fastened.
5. Turn the key to the OFF position.

Troubleshooting

⚠ WARNING

Bed lifting systems may cause death, serious injury or property damage if improperly used. When operating the bed lifting system, clear operation area of obstructions. Do not reach into the bed lifting system components while the system is being operated.

Advanced Control System (ACS) Stop Setting Procedure

The bed lift pre-set stops for the Up and Down positions are determined at the OEM Installation. If for any reason the bed lift's up or down position needs adjusting, do the following procedures:

Setting the UP Position

1. Make sure the safety belts are unfastened.
2. Turn the key switch to the ON position (Fig. 1D) located on the key pad.
3. Press and hold the UP arrow-shaped switch (Fig. 1A) on the key pad. A green LED light (Fig. 1C) on the key pad will turn on in the direction the bed is moving. The bed will keep moving until you reach the pre-set stop position.
4. If the bed lift stops too low, turn the white screw (Fig. 2A) in the ACS module counterclockwise. This will allow the bed lift to move higher. If the bed lift stops too high, turn the white screw (Fig. 2A) clockwise until the bed lift stops lower.

NOTE: One full rotation of the screw is approximately one inch of movement up or down.

5. Press the UP arrow (Fig. 1A) and DOWN arrow (Fig. 1B) to run the bed lift system after each adjustment of the screw. If necessary, repeat this procedure until desired stop location is obtained.

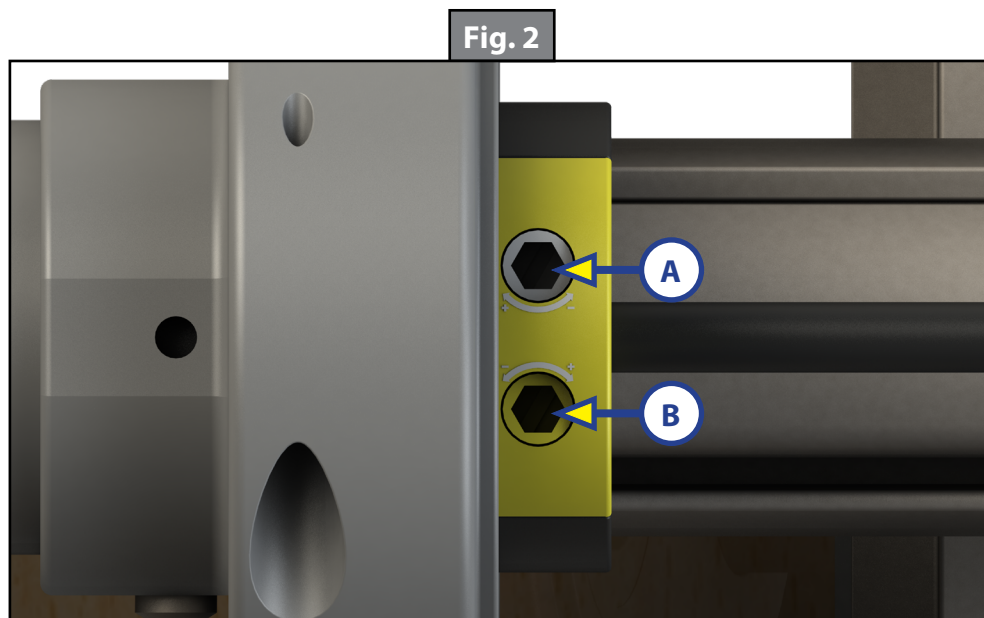

Fig. 2

Setting the DOWN Position

1. Make sure the safety belts are unfastened.
2. Turn the key switch to the ON position (Fig. 1D) located on the key pad.
3. Press and hold the DOWN arrow-shaped switch (Fig. 1B) on the key pad. A green LED light (Fig. 1C) on the key pad will turn on in the direction the bed is moving. The bed will keep moving until you reach the pre-set stop position.
4. If the bed lift stops too high, turn the yellow screw (Fig. 2B) counterclockwise. This will allow the bed lift to move lower. If the bed lift stops too low, turn the yellow screw (Fig. 2B) clockwise until the bed lift stops higher.

NOTE: One full rotation of the screw is approximately one inch of movement up or down.

5. Press the UP arrow (Fig. 1A) and DOWN arrow (Fig. 1B) to run the bed lift system after each adjustment of the screw. If necessary, repeat this procedure until desired stop location is obtained.

Manual Override

⚠ WARNING

Always disconnect from power source before performing any operation on the bed lifting system.

To raise or lower the bed lift In case of emergency, it is possible to operate the system manually.

1. Insert the provided crank device (Fig. 3A) into the motor (Fig. 3B).
2. Turn clockwise to raise or counterclockwise to lower the bed.
3. Have the bed lift serviced by an OEM-authorized dealer as soon as possible. Do not operate the bed lift until service is complete, as damage to the bed lift system may result.

Fig. 3

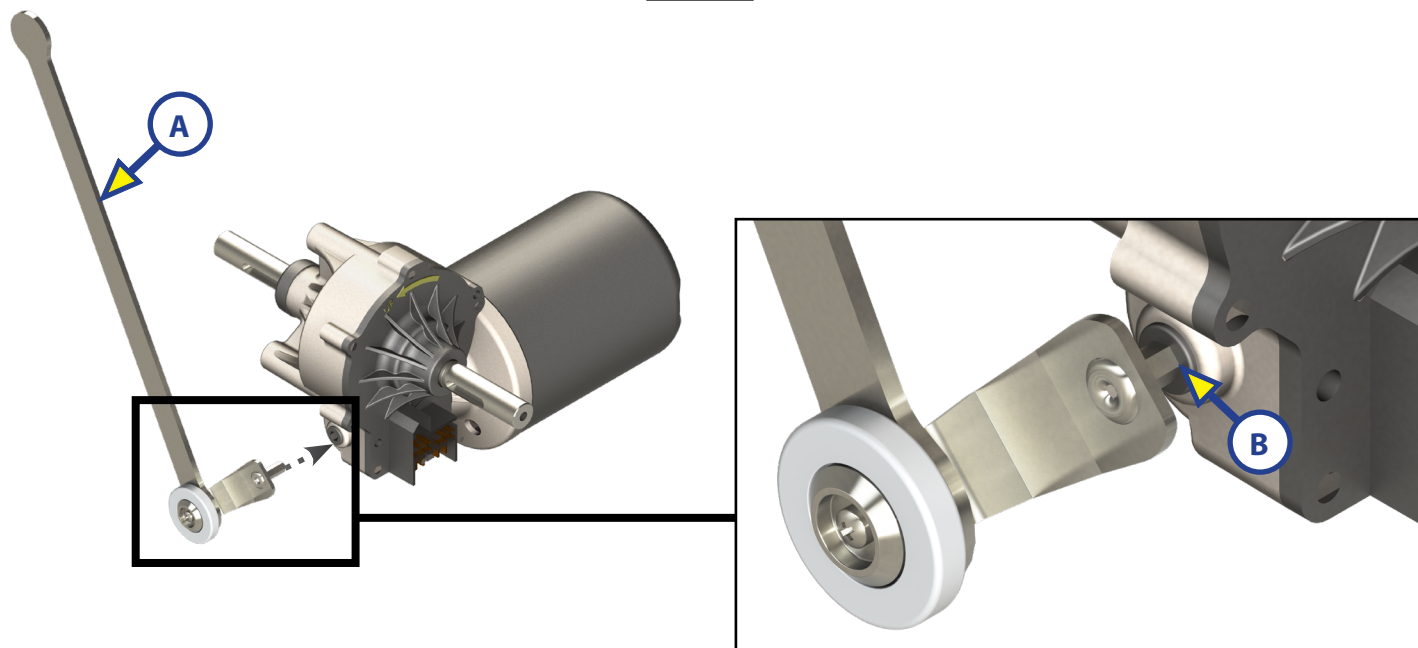

Maintenance

The EuroLoft Bed Lift system has been designed to require very little maintenance. To ensure the long life of your EuroLoft Bed Lift system, read and follow these few simple procedures:

- When the bed is raised, visually inspect the slide rail assemblies. Check for excess buildup of dirt or other foreign material. Remove any debris that may be present.
- If the system squeaks or makes any noises, blow out any debris from the drive shaft and apply a dry lubricant to prevent and/or stop squeaking.

Notes

This image shows a single sheet of white paper with horizontal ruling lines. The lines are evenly spaced and run across the width of the page. There are no margins, text, or other markings on the paper.



The contents of this manual are proprietary and copyright protected by Lippert. Lippert prohibits the copying or dissemination of portions of this manual unless prior written consent from an authorized Lippert representative has been provided. Any unauthorized use shall void any applicable warranty. The information contained in this manual is subject to change without notice and at the sole discretion of Lippert. Revised editions are available for free download from lippert.com.

Please recycle all obsolete materials.

For all concerns or questions, please contact Lippert
Ph: 432-LIPPERT (432-547-7378) | Web: lippert.com | Email: customerservice@lci1.com