

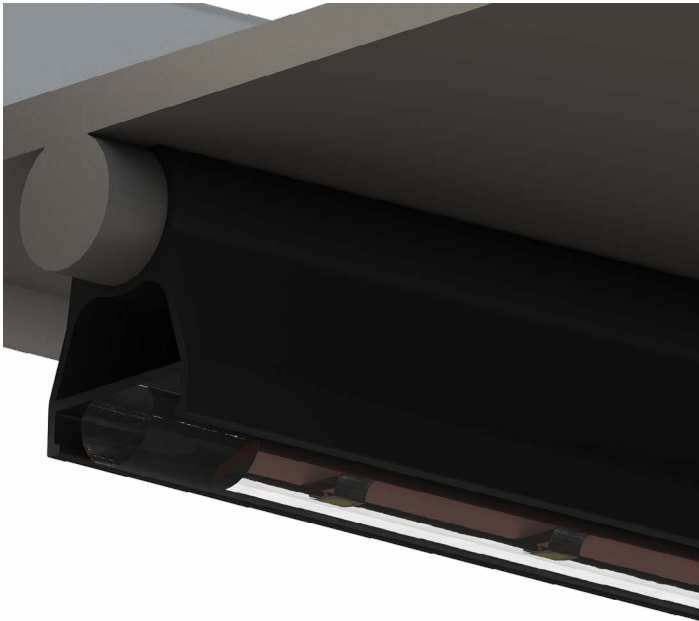

LIPPERT
COMPONENTS®



Solera® Awning LED Light Strip Kit Installation and Owner's Manual

(For Aftermarket Applications)

Table of Contents

Introduction	2
Safety	2
Parts List	3
Resources Required	3
Preparation	3
Custom Sizing of the LED Light Strip	3
Removing the Old LED Light Strip	4
Installation	4
LED Light Strip	4
LED Light Switch Installation	5
Wiring Diagrams	6
Front of Switch	6
Back of Switch	6
LED Light Switch Operation	6
Notes	7-8

Solera® Awning Aftermarket LED Light Strip Kit

Part #	Description
674282	15' Solera Awning LED Light Strip kit
674283	21' Solera Awning LED Light Strip Kit



LIPPERT
COMPONENTS®

Solera® Awning LED Light Strip Kit

Installation and Owner's Manual

(For Aftermarket Applications)

Introduction

The flexible light strip slides onto an integrated light cord included on all Solera® Universal Awning Fabric, the Prep Flex or Fabled Fabric Awning. The innovative design allows you to enjoy dramatic lighting outside of the RV when the awning is extended or retracted.

NOTE: Images used in this document are for reference only when assembling, installing and/or operating this product. Actual appearance of provided and/or purchased parts and assemblies may differ.

Additional information about this product can be obtained from lci1.com/support or by using the myLCI app. Replacement kits can be ordered from <https://store.lci1.com/> or by using the myLCI app.

The myLCI app is available for free on iTunes® for iPhone® and iPad® and also on Google Play™ for Android™ users.

iTunes®, iPhone®, and iPad® are registered trademarks of Apple Inc.

Google Play™ and Android™ are trademarks of Google Inc.

NOTE: This manual will refer to the “drive side” and “idler side” throughout for various instructions. The “drive side” is the right hand side of the awning when facing the awning from the exterior of the unit. The “idler side” is the left hand side of the awning when facing the awning from the exterior of the unit.

Safety

Read and fully understand all instructions before installing or operating this product. Adhere to all safety labels.

This manual provides general instructions. Many variables can change the circumstances of the instructions, i.e., the degree of difficulty, operation and ability of the individual performing the instructions. This manual cannot begin to plot out instructions for every possibility, but provides the general instructions, as necessary, for effectively interfacing with the device, product or system. Failure to correctly follow the provided instructions may result in death, serious personal injury, severe product and/or property damage, including voiding of the LCI limited warranty.

CAUTION

MOVING PARTS CAN PINCH, CRUSH, OR CUT. KEEP CLEAR AT ALL TIMES.



Solera® Awning LED Light Strip Kit

Installation and Owner's Manual

(For Aftermarket Applications)

Parts List

NOTE: Part numbers are shown for identification purposes only. Not all parts are available for individual sale. All parts with a link to the Lippert Store can be purchased.

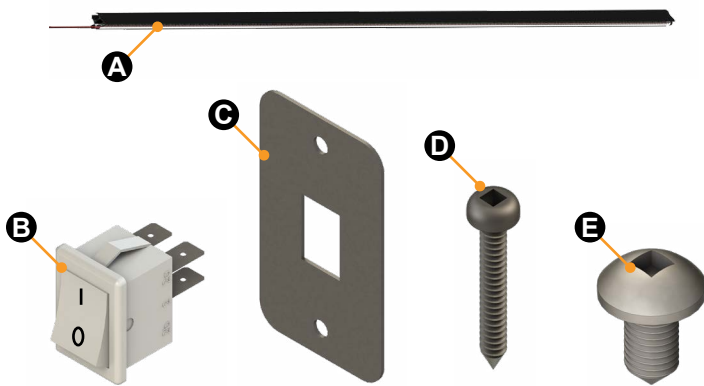

15' Solera® Awning Aftermarket LED Light Strip Kit PN 674282			
Letter	PN	Description	Qty
A	387593	15' LED Light Strip	1
B	431032	Light Switch	1
C	431033	Light Switch Plate	1
D	227619	#8 x 1" Square Pan Head Screw	2
E	388271	#10 - 16 x 3/8" Pan Head Screw	1

21' Solera® Awning Aftermarket LED Light Strip Kit PN 674283			
Letter	PN	Description	Qty
A	387594	21' LED Light Strip	1
B	431032	Light Switch	1
C	431033	Light Switch Plate	1
D	227619	#8 x 1" Square Pan Head Screw	2
E	388271	#10 - 16 x 3/8" Pan Head Screw	1

Resources Required

- Cordless or electric drill or screw gun
- Appropriate drive bits
- Cordless or electric saw
- Appropriate cutting blades
- Sharp scissors, if applicable
- Fuse appropriate for wiring
- Silicone sealant
- Marker

Preparation

Custom Sizing of the LED Light Strip

There are two available sizes for the awning fabric LED light strip kit. If the awning width, measuring the awning fabric edge-to-edge, measures 10' - 15' the 15' LED light strip kit should be used. If the awning fabric measures 16' - 21' the 21' awning LED light kit should be used. To achieve a custom size, the LED light strip can be cut along the black line at the nearest copper cut tab (Fig.1A).

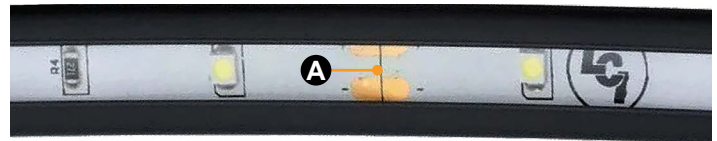

Fig.1

NOTE: If cutting the LED light strip is required, it is very important to cut only on the given cut line between the copper cut tabs (Fig.1A). Cutting through or before the copper cut tabs will result in no electrical conductivity to the following section.

1. At the closest applicable length needed, usually the width of the awning fabric, measure from the wired side out.
2. Cut the excess light strip from the opposite side of the wiring on the LED light strip. Use a pair of sharp scissors to cut the LED light strip directly down the given cut line (Fig.1A).
3. Seal the LED light strip cut end with a dab of silicone along the edge and let dry.



Solera® Awning LED Light Strip Kit

Installation and Owner's Manual

(For Aftermarket Applications)

Removing the Old LED Light Strip

NOTE: Awning **MUST** be extended to access the polycord on the awning fabric and the LED power wires down the drive mount arm.

1. If replacing only the LED light strip, remove the old LED light strip by locating and removing the #10 - 16 x 3/8" pan head screw (Fig.2A) located on the drive side, in the back of the LED light strip, holding the LED light strip in place.

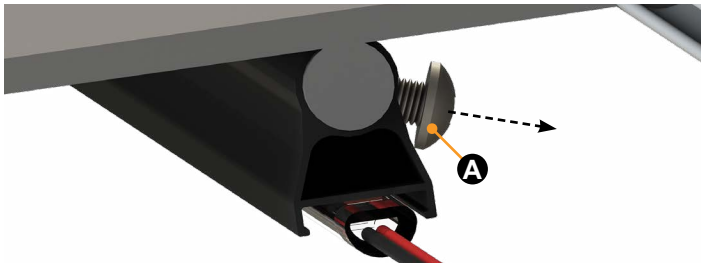

Fig.2

2. Cut the wires to the old LED light strip just inside the wall of the unit. The wires to the new LED light strip can be spliced into the old wires rather than replacing all the wiring to the switch and power source and replacing the switch.

3. Remove the old LED light strip by sliding the LED light strip completely out from the awning fabric polycord.

NOTE: If the light switch needs to be replaced as well, remove the two #8 x 1" pan head screws in the light switch plate (Fig.5B). Remove the light switch, plate and disconnect the wiring to the LED light strip and the power source.

Installation

LED Light Strip

NOTE: Awning **MUST** be extended to access the polycord on the awning fabric and to run the LED power wire down the drive mount arm.

1. Starting on the drive side of the awning, slide the LED light strip (non-wired end) (Fig.3A) onto the polycord of the awning fabric (Fig.3B), located close to the awning rail (Fig.3C) down the width of the awning fabric to the end, towards the idler side.

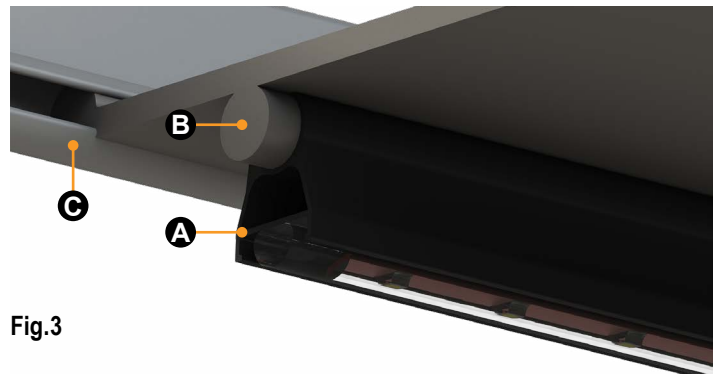

Fig.3

2. Flip the LED light strip drive side (wired end) up to see the back side of the light strip.

3. Install a #10 - 16 x 3/8" pan head screw (Fig.4A) into the black plastic track of the LED light strip. Make sure to install the screw at a slight angle in between the LED light strip and the polycord in the awning fabric, to prevent the LED light strip from sliding off the awning fabric polycord.

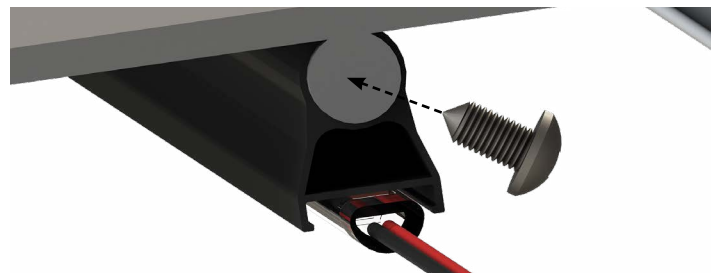

Fig.4



Solera® Awning LED Light Strip Kit

Installation and Owner's Manual

(For Aftermarket Applications)

NOTE: Make sure the screw does not completely go through the polycord and into the awning fabric. Make sure that the LED light strip is hanging straight, parallel to the ground.

4. Depending on top wire or bottom wire installation, remove the wire covers in the drive side mount arm.

5. If bottom installation, take the LED light strip power wire (Fig.5A) from the light track and run it down the drive arm.

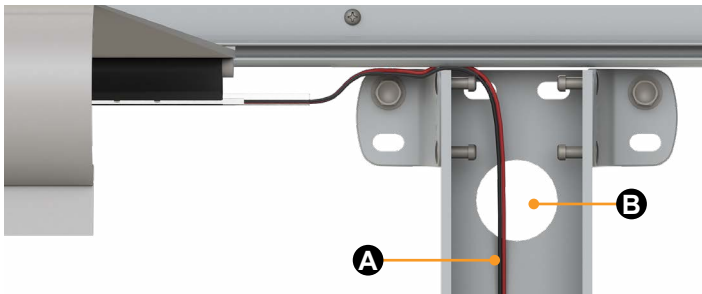

Fig.5

Make sure to run the wires over the center pin of the drive mount arm. If top installation, run the wires through the top hole in the drive side mount arm (Fig.5B) inside the unit wall and down to the switch.

NOTE: If completing an entirely new installation, proceed to the LED Light Switch Installation

6. Splice the new LED light strip power wires onto the old wires just inside the unit's wall.

NOTE: Make sure the red wire is to power and the black wire is to ground.

7. Test the light switch to make sure the LED light strip is wired properly.

8. Reinstall wire covers in the drive mount arm.

LED Light Switch Installation

1. Determine where to mount the LED light switch. The LED light switch can be mounted anywhere inside the trailer or trailer compartment. The mounting location must be watertight. The typical location for the LED light switch is near the entry door, close to where the wires from the LED light strip enter inside the unit wall.

2. Cut a hole in the wall or wall of the compartment using the inside opening of the switch plate as a guide (Fig.6D). Use the switch plate to trace where the cutout should be located. The top and bottom horizontal cuts should be parallel.

3. Place the light switch (Fig.6C) into the switch plate (Fig.6A).

NOTE: Make sure the switch is oriented correctly with the on position (vertical line) located at the top of the switch.

4. Located on the backside of the light switch, insert the LED light strip wires onto the proper spade. Red wire is positive, black wire is negative.

5. Connect the LED red power wire to the unit's power source. Make sure the black wire is connected to a ground and the red wire is connected to 12V DC power source

6. Connect the 3A fuse to protect all wiring going to the light, that meets or exceeds RVIA standards. See the Wiring Diagram section.

7. Test the light switch to make sure the LED light strip is wired properly.

8. Secure the switch plate onto the unit wall with the two provided #8 x 1" pan head screws (Fig.6B).

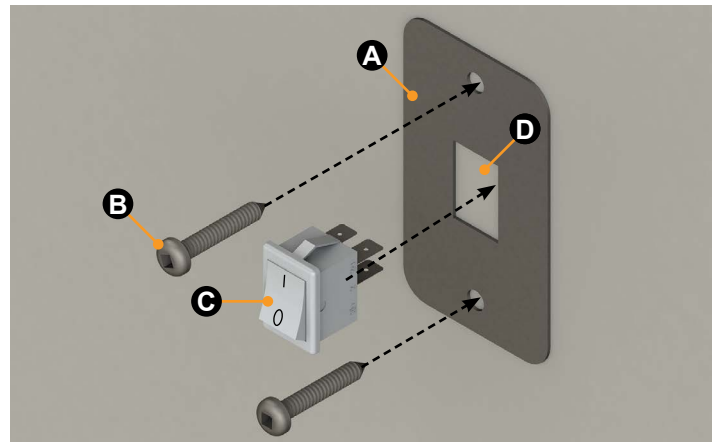
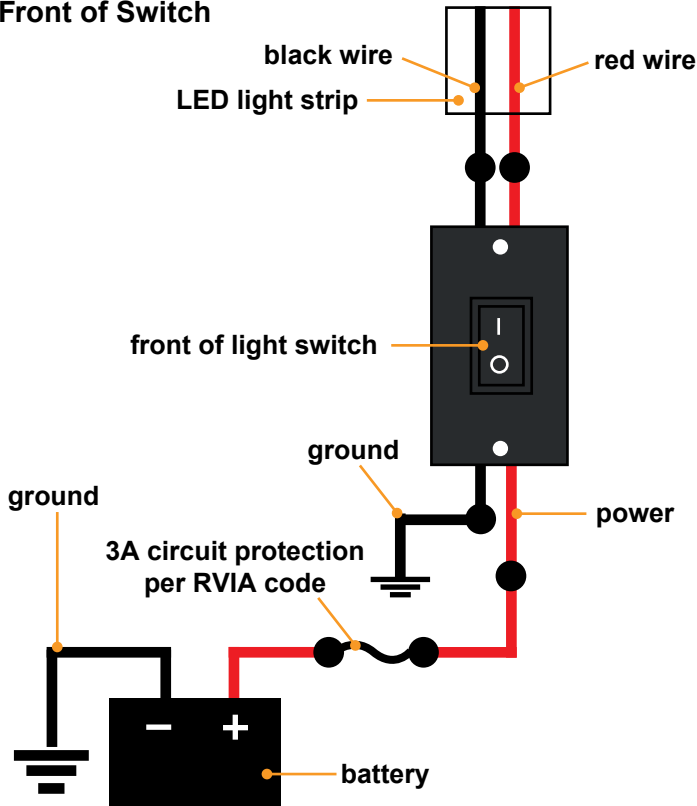

Fig.6



Wiring Diagrams

Front of Switch



LED Light Switch Operation

NOTE: Leaving the LED light strip switch on for an extended period of time can drain the trailer's battery.

1. To turn the LED light strip on, press the toggle switch to the vertical line symbol (Fig.7A).
2. To turn the LED light strip off, press the toggle switch to the circle symbol (Fig.7B).

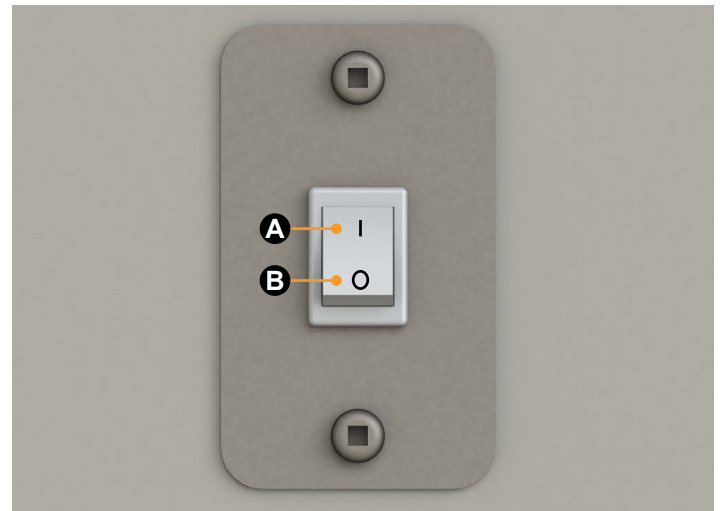
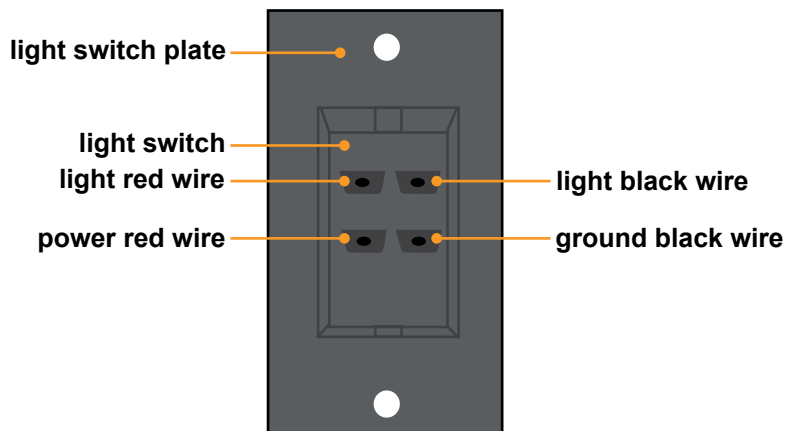

Fig.7

Back of Switch





LIPPERT
COMPONENTS®

**Solera® Awning LED
Light Strip Kit**
Installation and Owner's Manual
(For Aftermarket Applications)

Notes

Lined area for notes, consisting of two columns of horizontal lines.



LIPPERT
COMPONENTS®

Manual information may be distributed as a complete document only, unless Lippert Components provides explicit consent to distribute individual parts.

All manual information is subject to change without notice. Revised editions will be available for free download at lci1.com. Manual information is considered factual until made obsolete by a revised version.

Please recycle all obsolete materials and contact Lippert Components with concerns or questions.