



# Lippert Insight Back-up Camera LCD Display Kit Installation and Owner's Manual (For Aftermarket Applications)

Lippert Insight Camera LCD 7" Display Kit

Kit #	Description
<a href="#">2020112848</a>	Insight LCD 7" Display

## Table of Contents

Introduction .....	2
Safety .....	2
Parts List .....	2
Resources Required .....	2
Installation .....	3
Operation .....	4
Screen Menu .....	5
Troubleshooting .....	6
Notes .....	7



# Lippert Insight Back-up Camera LCD Display Kit

## Installation and Owner's Manual

(For Aftermarket Applications)

## Introduction

The Lippert Insight Back-up Camera LCD Display Kit is a 7" camera display, mounting arm and USB power cord that streams wireless video from your Lippert back-up camera.

Additional information about this product can be obtained from [lci1.com/support](http://lci1.com/support) or by using the myLCI app. Replacement kits can be ordered from <https://store.lci1.com/electronics> or by using the myLCI app.

The myLCI app is available for free on Apple App Store® for iPhone® and iPad® and also on Google Play™ for Android™ users.

Apple App Store®, iPhone®, and iPad® are registered trademarks of Apple Inc.

Google Play™ and Android™ are trademarks of Google Inc.

## Safety

Read and understand all instructions before installing or operating this product. Adhere to all safety labels. This manual provides general instructions. Many variables can change the circumstances of the instructions, i.e., the degree of difficulty, operation and ability of the individual performing the instructions. This manual cannot begin to plot out instructions for every possibility, but provides the general instructions, as necessary, for effectively interfacing with the device, product or system. Failure to correctly follow the provided instructions may result in death, serious personal injury, severe product and/or property damage, including voiding of the Lippert limited warranty.

### **⚠ CAUTION**

THE "CAUTION" SYMBOL ABOVE IS A SIGN THAT A PROCEDURE HAS A SAFETY RISK INVOLVED AND MAY CAUSE PERSONAL INJURY, PRODUCT AND/OR PROPERTY DAMAGE IF NOT PERFORMED SAFELY AND WITHIN THE PARAMETERS SET FORTH IN THIS MANUAL.

### **⚠ CAUTION**

MOVING PARTS CAN PINCH, CUT, AND CRUSH. KEEP HANDS OFF MOVING PARTS AT ALL TIMES AND EXERCISE CAUTION WHEN EXTENDING OR RETRACTING THE LADDER.

## Parts List



**Lippert Insight LCD Display Kit—2020112848**

Letter	Part Number	Description	Qty
A	N/A	7" Display	1
B	N/A	USB cord	1
C	N/A	Mounting arm	1

**NOTE:** Part numbers are shown for identification purposes only. Not all parts are available for individual sale. All parts with a link to the Lippert Store can be purchased.

## Resources Required

- Ladder



# Lippert Insight Back-up Camera LCD Display Kit Installation and Owner's Manual (For Aftermarket Applications)

## Installation

1. Remove the Lippert Insight Back-up Camera LCD Display Kit from the packaging.
2. Clean area on dashboard or windshield where mounting arm will rest.
3. Remove the protective film from the bottom of the mounting arm (Fig. 1).



Fig.1

4. Secure mounting arm on dashboard or windshield by pressing down (Fig.2) on center and tightening the latch (Fig.3).



Fig.2



Fig.3

5. Once mounting arm is secure in desired area, attach the 7" display screen to the mounting arm by sliding the slots located on the back of the display over the tabs on the mounting arm (Fig.4).

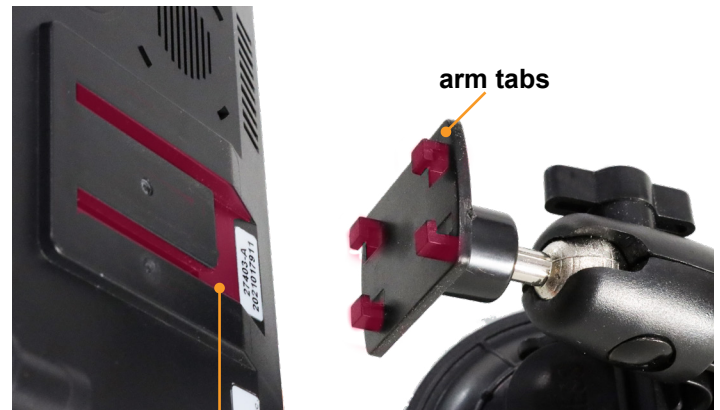

Fig.4

6. Adjust display screen by loosening and tightening the display knob on the left side of the mounting arm (Fig.5).



Fig.5

7. Attach the USB power cord to the display screen (Fig.6).



Fig.6



# Lippert Insight Back-up Camera LCD Display Kit

## Installation and Owner's Manual

(For Aftermarket Applications)

## Operation

1. Turn on tow vehicle marker/running lights to ensure that the camera is powered.
2. Display screen will power up, with screen shown (Fig. 7).



Fig.7

3. In the top left corner are three menu bars (Fig.8). Tap the menu bars to navigate to the main menu.

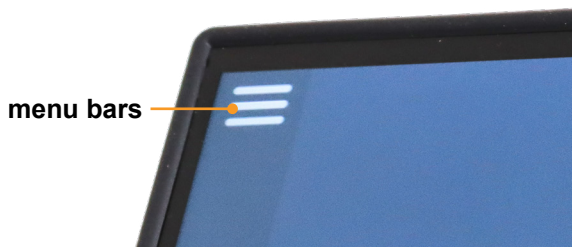

Fig.8

4. Select camera pairing (Fig.9A)



Fig.9

5. Exit vehicle and proceed to camera location on the back of the unit (Fig.10A).

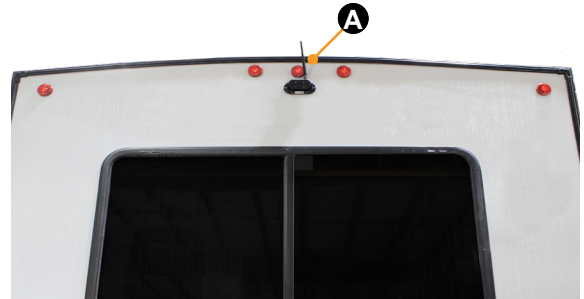

Fig.10

6. On the bottom of the camera is a reset button (Fig.11). Using a pen or the end of a paperclip, press and hold the reset button for 15 seconds.



Fig.11

reset button

**NOTE:** During reset, the four red LEDs (Fig.12) around the camera light should light up for approximately 1 second.



Fig.12

LED Lights

7. The camera and display should be now be paired.

**NOTE:** If camera and display have not paired, repeat pairing process or refer to "Troubleshooting."

8. Tap the menu bars to return to the main menu and select the desired action.





# Lippert Insight Back-up Camera LCD Display Kit Installation and Owner's Manual (For Aftermarket Applications)

## Screen Menu

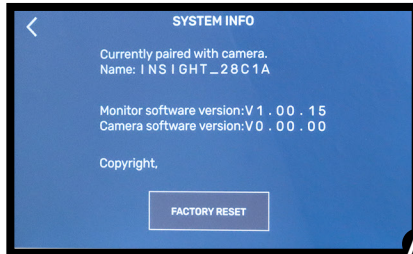

**System Info:** Shows current camera paired, current software version and has a factory reset option.

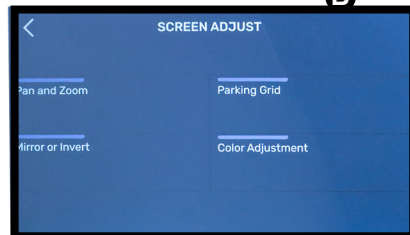

**Screen Adjust:** Allows pan and zoom view from the camera. Parking Grid gives accurate perspectives. Color Adjustment allows changes in contrast and/or saturation levels. Mirror or invert changes camera image orientation to the display.

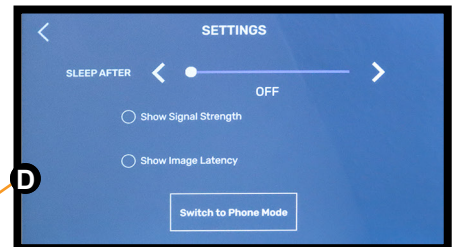

**Settings:** Allows setting of the display to go to sleep after selected amount of time. Gives option to view wireless strength and image latency. Option to switch to mobile device.

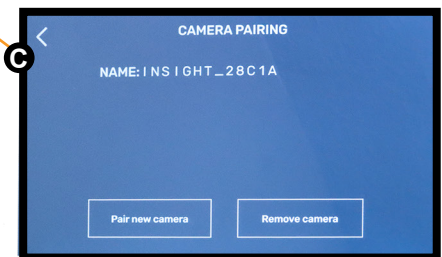

**Camera Pairing:** Displays current camera paired with display. Allows removal of camera if new camera is needed. Allows pairing with new camera.



## **Lippert Insight Back-up Camera LCD Display Kit Installation and Owner's Manual (For Aftermarket Applications)**

### **Troubleshooting**

<b>What Is Happening?</b>	<b>Why?</b>	<b>What Should Be Done?</b>
Display does not connect to camera.	Camera not powered up. Turn battery disconnect on.	Connect to shore power. Connect 7-way to tow vehicle.
Camera not powering up	Marker/running lights are OFF.	Turn marker/running lights on tow vehicle or trailer.
Camera is displaying a blank screen after connection.	Another mobile device is connected to the camera.	Power down or restart other connected mobile devices.
	Cycle power to unit.	Remove power from camera for two minutes by cycling battery disconnection and reconnection of shore power and the 7-way connector, or by turning the running/marker lights on and off.

If further assistance is required, please contact the Lippert Customer Care Center at 432-LIPPERT (432-547-7378).

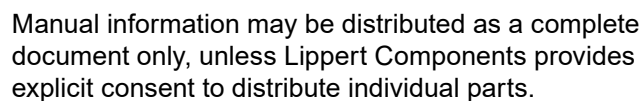

## This image shows a blank sheet of white paper with horizontal ruling lines. The lines are evenly spaced and run across the width of the page. There are no margins, text, or other markings on the paper.

[illegible][illegible]

All manual information is subject to change without notice. Revised editions will be available for free download at [lippert.com](http://lippert.com). Manual information is considered factual until made obsolete by a revised version.

Please recycle all obsolete materials and contact Lippert Components with concerns or questions.