



# Rockport Pontoon Furniture Installation and Owner's Manual

(For Aftermarket Applications)

## Introduction

Lippert Rockport replacement pontoon furniture is designed for quick and easy installation on most pontoons. Built for long-lasting durability, the rotationally-molded poly base provides sturdy support, while the UV- and weather-resistant vinyl keeps your furniture looking sharp and performing well — resistant to fading, cracking, and mildew buildup. This pontoon seat makes the most of your floorplan with options for standalone installation or integration with existing seats. With Lippert, you get the perfect combination of quality, function, and durability in every piece.

Additional information about this product can be obtained from [lci1.com/support](https://lci1.com/support) or by using the LippertNOW app. Replacement kits can be ordered from <https://store.lci1.com/> or by using the LippertNOW app.

The LippertNOW app is available for free on Apple App Store® for iPhone® and iPad® and also on Google Play™ for Android™ users.

App Store® and iPad® are registered trademarks of Apple Inc. Google Play™ and Android™ are trademarks of Google Inc.

For additional support on this product,  
scan this QR code or go to:

[support.lci1.com/marine-furniture](https://support.lci1.com/marine-furniture)



## Table of Contents

Introduction .....	1
Safety .....	2
Resources Required .....	2
Preparation .....	2
Installation .....	3
Maintenance .....	3
Notes .....	4



# Rockport Pontoon Furniture

## Installation and Owner's Manual

(For Aftermarket Applications)

## Safety

Read and understand all instructions before installing or operating this product. Adhere to all safety labels. This manual provides general instructions. Many variables can change the circumstances of the instructions, i.e., the degree of difficulty, operation and ability of the individual performing the instructions. This manual cannot begin to plot out instructions for every possibility, but provides the general instructions, as necessary, for effectively interfacing with the device, product or system. Failure to correctly follow the provided instructions may result in death, serious personal injury, severe product and/or property damage, including voiding of the Lippert limited warranty.

### ⚠ WARNING

THE "WARNING" SYMBOL ABOVE IS A SIGN THAT A PROCEDURE HAS A SAFETY RISK INVOLVED AND MAY CAUSE DEATH OR SERIOUS PERSONAL INJURY IF NOT PERFORMED SAFELY AND WITHIN THE PARAMETERS SET FORTH IN THIS MANUAL.

### ⚠ CAUTION

THE "CAUTION" SYMBOL ABOVE IS A SIGN THAT A SAFETY RISK IS INVOLVED AND MAY CAUSE PERSONAL INJURY AND/OR PRODUCT OR PROPERTY DAMAGE IF NOT SAFELY ADHERED TO AND WITHIN THE PARAMETERS SET FORTH IN THIS MANUAL.

## Resources Required

- Cordless or electric drill or screw gun
- Tape measure
- Appropriate drill bits
- #10 galvanized screws
- Ratchet set

## Preparation

1. Before ordering your furniture, strip the existing furniture off of the boat.
2. Inspect the flooring and subfloor to make sure they are in good condition.
3. Measure the deck from bow to stern and measure the beam length, taking into consideration any bracketry or previous mounting locations that may interfere with your installation.

**NOTE:** When ordering furniture, take into consideration the corner bow radius (Fig. 1A), door placement and direction, and any support brackets.

**NOTE:** When you receive your furniture, inspect the boxes for any damage that may have occurred in transit.

### ⚠ CAUTION

USE CAUTION WHEN OPENING SHIPPING BOXES TO AVOID DAMAGING FURNITURE. AVOID USING KNIVES OR LONG BLADES WHEN OPENING SHIPPING BOXES. FURNITURE MAY BE PACKED TIGHTLY IN BOXES.

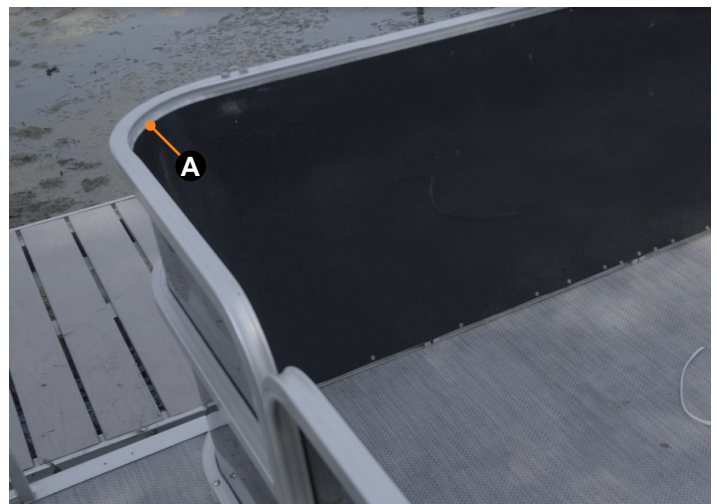

Fig.1

# Rockport Pontoon Furniture

## Installation and Owner's Manual

(For Aftermarket Applications)

## Installation

1. Install the provided threaded studs (Fig. 2A) into the pre-drilled holes in the bottom of the seatback and hand-tighten.



Fig.2

2. Place the seatback (Fig. 3A) on the molded base (Fig. 3B) so that the threaded studs enter the pre-drilled holes in the molded base. Secure the threaded studs to the base using the provided washers and nuts.

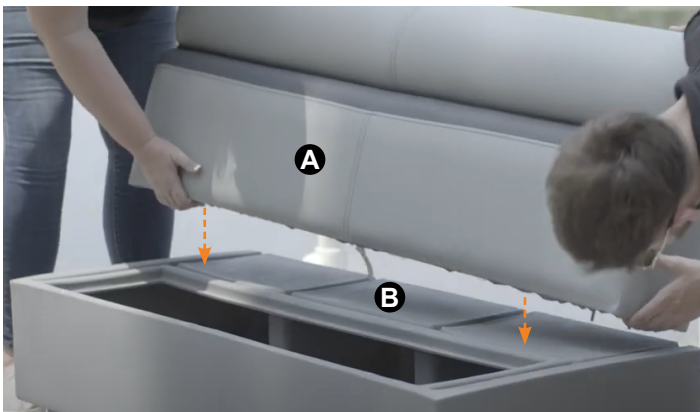

Fig.3

3. Attach the seat base (Fig. 4A) to the molded base (Fig. 4B) by inserting the provided screws through the hinges (Fig. 4C) into the pre-drilled holes.

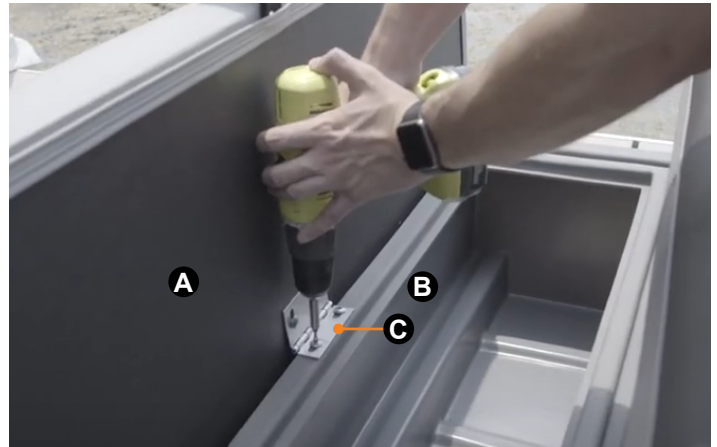

Fig.4

4. Place the seat in the desired position and secure to the deck using four #10 galvanized screws (Fig. 5).

**NOTE:** If this seat is being used to replace an old seat, the old fasteners may be re-used.



Fig.5

## Maintenance

- To clean seats, wash with mild soap and water and dry thoroughly. Avoid harsh chemicals that can damage the material.
- Cover seats when not in use.



# Rockport Pontoon Furniture

Installation and Owner's Manual  
(For Aftermarket Applications)

## Notes



Manual information may be distributed as a complete document only, unless Lippert provides explicit consent to distribute individual parts.

All manual information is subject to change without notice. Revised editions will be available for free download at [lippert.com](http://lippert.com). Manual information is considered factual until made obsolete by a revised version.

Please recycle all obsolete materials and contact Lippert with concerns or questions.