

SureShade® Power Bimini Upgrades: Fly Extension

Installation and Owner's Manual (For Aftermarket Applications)

Table of Contents

Introduction	2
Safety	2
Parts List	3
Resources Required	3
Installation	3
Front Fly Extension	3
Reverse (rear) Fly Extension	9
Operation	10
Front Fly Extension	10
Reverse (rear) Fly Extension	10
Storage	10
Troubleshooting	11
Maintenance	11
Fabric Care	11
Notes	12

Bimini Extension Kits	
Part #	Description
2021013744	Bimini Extension Kit with Black Hardware; 7ft with Black Canvas
2022002186	Bimini Extension Kit with Chrome Hardware; 7ft with Black Canvas
2022002187	Bimini Extension Kit with Black Hardware; 6ft with Black Canvas
2022002188	Bimini Extension Kit with Chrome Hardware; 6ft with Black Canvas
2022002189	Bimini Extension Kit with Chrome Hardware; 7ft with Light Sand Canvas
2022002190	Bimini Extension Kit with Chrome Hardware; 6ft with Light Sand Canvas



Introduction

Protection from the elements while spending time on your pontoon makes for a great day. Our bimini extension kit easily connects to our canopies with the front, zippered storage pocket. This nylon bimini extension protects against harsh UV rays and rain.

The bimini extension kit is also easily customizable for use towards the rear of the boat, running underneath the canopy to provide additional protection when and where needed.

Additional information about this product can be obtained from lci1.com/support or by using the LippertNOW app. Replacement kits can be ordered from <https://store.lci1.com/> or by using the LippertNOW app.

The myLCI app is available for free on Apple App Store® for iPhone® and iPad® and also on Google Play™ for Android™ users.

App Store® and iPad® are registered trademarks of Apple Inc.

Google Play™ and Android™ are trademarks of Google Inc.

Safety

Read and understand all instructions before installing or operating this product. Adhere to all safety labels.

This manual provides general instructions. Many variables can change the circumstances of the instructions, i.e., the degree of difficulty, operation and ability of the individual performing the instructions. This manual cannot begin to plot out instructions for every possibility, but provides the general instructions, as necessary, for effectively interfacing with the device, product or system. Failure to correctly follow the provided instructions may result in death, serious personal injury, severe product and/or property damage, including voiding of the LCI limited warranty.

⚠ WARNING

THE “WARNING” SYMBOL ABOVE IS A SIGN THAT A PROCEDURE HAS A SAFETY RISK INVOLVED AND MAY CAUSE DEATH OR SERIOUS PERSONAL INJURY AND/OR SEVERE PRODUCT OR PROPERTY DAMAGE IF NOT PERFORMED SAFELY AND WITHIN THE PARAMETERS SET FORTH IN THIS MANUAL.

SureShade® Power Bimini Upgrades: Fly Extension

Installation and Owner’s Manual
(For Aftermarket Applications)

⚠ WARNING

FAILURE TO FOLLOW INSTRUCTIONS PROVIDED IN THIS MANUAL MAY RESULT IN DEATH, SERIOUS PERSONAL INJURY AND/OR SEVERE PRODUCT AND PROPERTY DAMAGE, INCLUDING VOIDING OF THE COMPONENT WARRANTY.

⚠ WARNING

DO NOT FULLY OPEN THE BIMINI FRAME WITHOUT THE CANVAS TOP INSTALLED. OPENING THE BIMINI FRAME WITHOUT THE CANVAS TOP INSTALLED WILL RESULT IN SEVERE PRODUCT DAMAGE. ONLY FULLY OPEN THE BIMINI FRAME WITH THE CANVAS TOP INSTALLED.

⚠ CAUTION

THE “CAUTION” SYMBOL ABOVE IS A SIGN THAT A SAFETY RISK IS INVOLVED AND MAY CAUSE PERSONAL INJURY AND/OR PRODUCT OR PROPERTY DAMAGE IF NOT SAFELY ADHERED TO AND WITHIN THE PARAMETERS SET FORTH IN THIS MANUAL.

⚠ CAUTION

ALWAYS WEAR EYE PROTECTION WHEN PERFORMING SERVICE, MAINTENANCE OR INSTALLATION PROCEDURES.

⚠ CAUTION

DO NOT EXCEED 15 MPH WHEN FLY EXTENSION IS DEPLOYED. EXCEEDING MAXIMUM SPEED LIMIT WITH FLY EXTENSION DEPLOYED CAN CAUSE DAMAGE TO THE EXTENSION AND VOID PRODUCT WARRANTY.

SureShade® Power Bimini Upgrades: Fly Extension

Installation and Owner's Manual
(For Aftermarket Applications)

Parts List

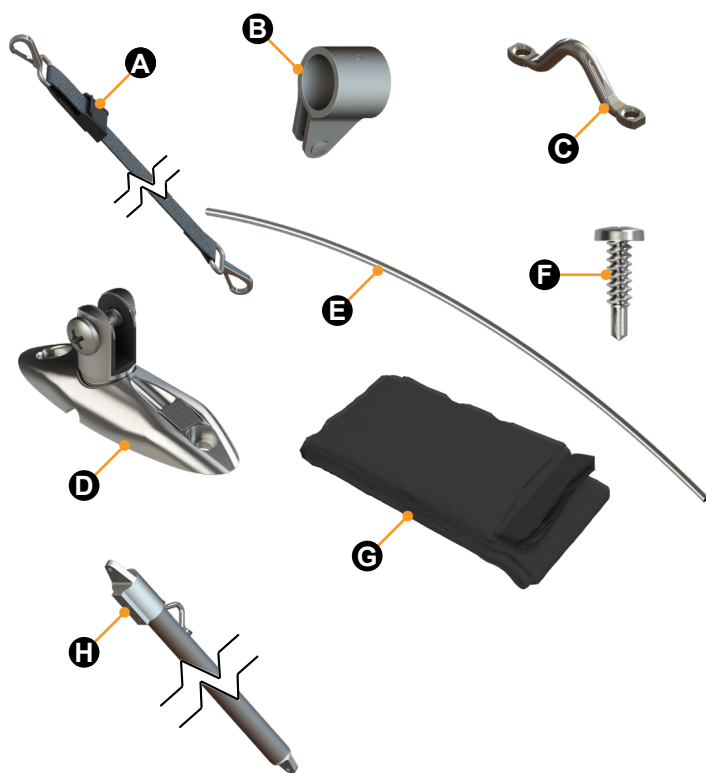

Letter	PN	Description	Qty
A	2021016767	Strap Assembly, 48"	2
B	2021013729	Jawslide, 0.984" Rnd, Closed SS	2
C	2021013733	Eye Strap (saddle)	4
D	2020104413	Quick Release Bimini Top Hinge Assembly	4
E	2021016592	Round Support Tube (2 pcs)	1
F	853953	Screw, 1/4"-10 x 3/4" RH PSV PH SLFDR SST	12
G	2021013519	Bimini Extension Fabric	1
H	2021102659	Bimini Support Arm Assembly	2

NOTE: Part numbers are shown for identification purposes only. Not all parts are available for individual sale. Parts may vary depending on kit. All parts with a link to the Lippert Store can be purchased.

Resources Required

- 1-2 persons, depending on task
- Cordless or electric drill or screw gun
- Appropriate drive bits
- Screwdriver
- Tape measure
- 1/8" hex wrench
- Non-permanent marker

Installation

The optional Lippert front fly extension can only be installed on bimini tops equipped with a zippered front storage pocket that accommodates the attachment and storage of the fly extension and stanchions. The stanchions are equipped with adjustable tie-down straps.

Front Fly Extension

NOTE: Inspect both sides, the front and rear of the boat for any interfering obstructions such as doors, furniture or other permanent features.

1. Fully extend the bimini top.
2. Unzip the top's front storage pocket.
3. Connect the zipper end of the fly extension fabric to the open zipper of the storage pocket, then zip it closed to secure the fly extension fabric to the top.
4. Unfurl and stretch the fly extension fabric towards the front of the boat.

5. Snap the two sections of the tube together (Fig.1).

NOTE: The round support tube for the front of the fly extension is shipped in two pieces.

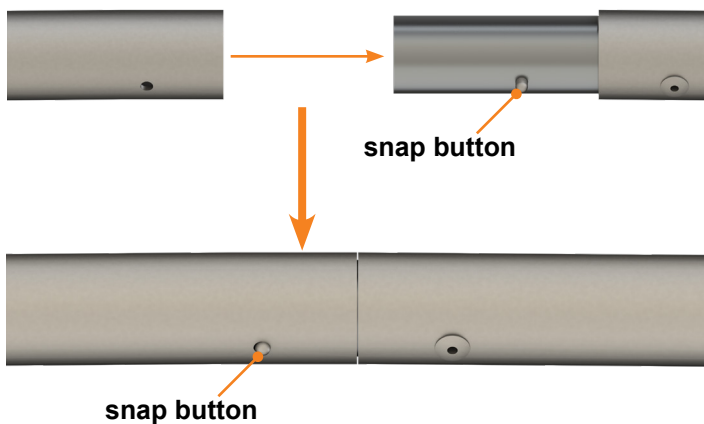

Fig.1

6. Position the tube so the ends curve upward and are vertically aligned to one another at the 12 o'clock position (Fig.2).

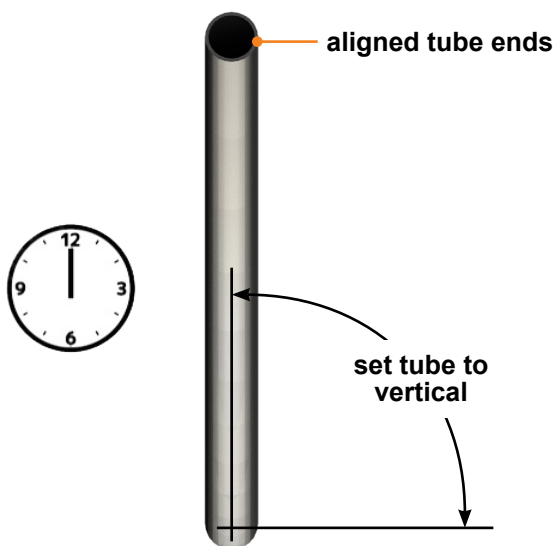

Fig.2

7. Use an 1/8" hex wrench to loosen the setscrew (Fig.3A) in a jawslide, remove the jaw screw (Fig.3B) then set the screw aside.

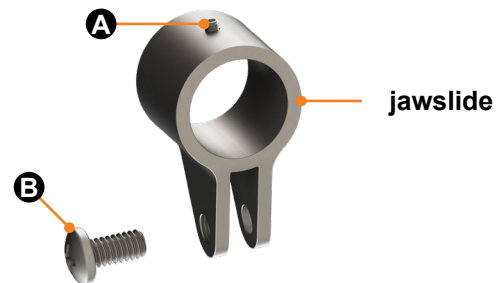

Fig.3

8. Slip the jawslide onto one end of the tube, position it flush to the end of the tube, then align the clamping jaw vertical to the tube ends (Fig.4).

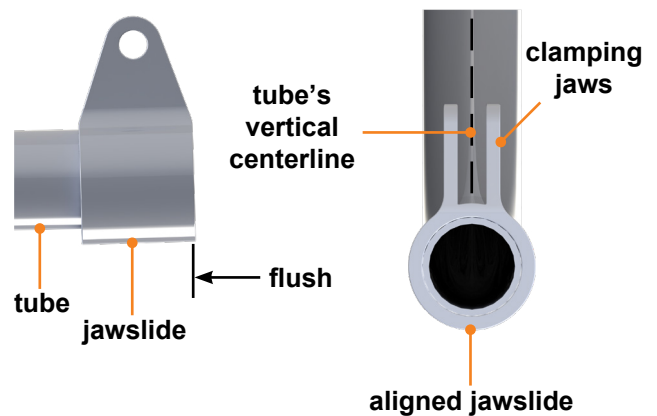

Fig.4

9. Rotate the jawslide to the 1 o'clock position (30 degrees) then secure it in place with the setscrew using an 1/8" hex wrench (Fig.5).

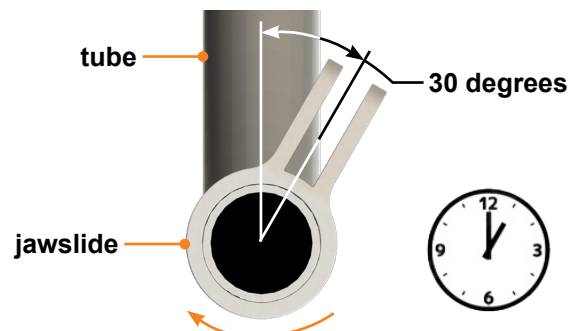

Fig.5

10. Repeat steps 7-9 on the other end of the tube. Make sure the two jawslides are aligned to one another.
11. Separate the two halves of the tube then slip the front pocket of the extension fabric over the collared tube (Fig.6).

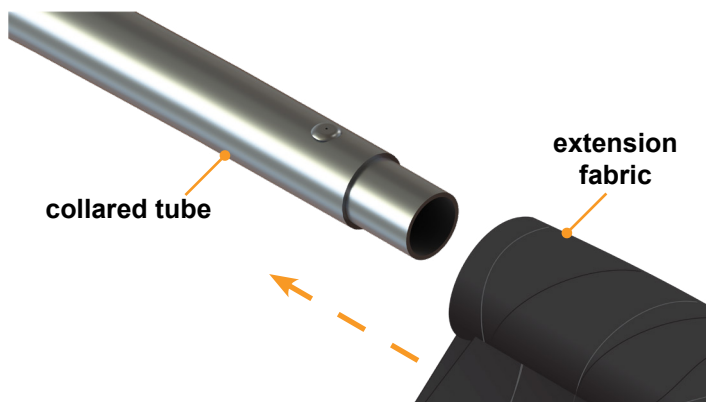

Fig.6

12. Reconnect the tube halves (Fig.7).

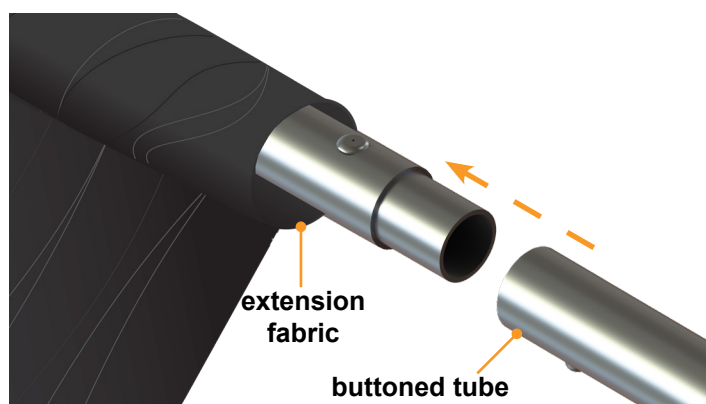

Fig.7

13. Spread the extension's fabric across the width of the tube (Fig.8).

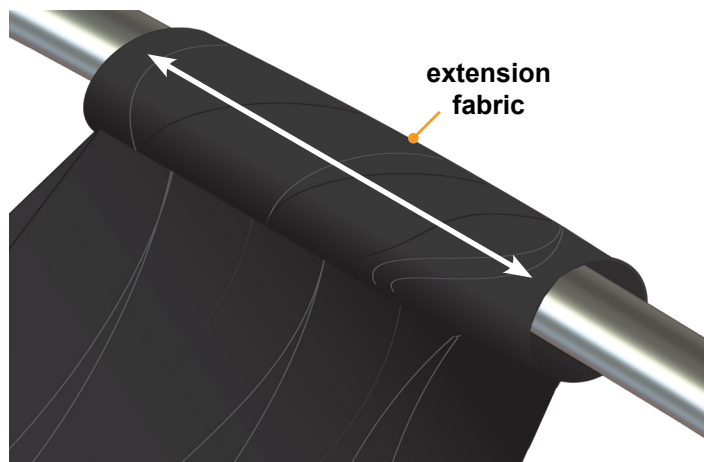

Fig.8

14. Slide the locking button (Fig.9A) on each locking plate back (Fig.9B) then remove the swivel locking studs (Fig.9C).

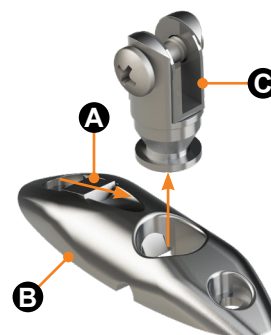

Fig.9

15. Use a screwdriver to install the swivel locking studs onto the bottoms of the stanchions (Fig.10).

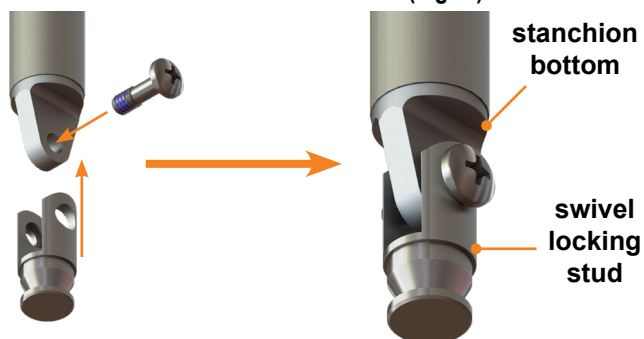

Fig.10

16. Retrieve the previously-removed (step 7) jaw screw (Fig.11A) and use it to secure the eye end of each stanchion (Fig.11B) onto a jaw slide (Fig.11C).

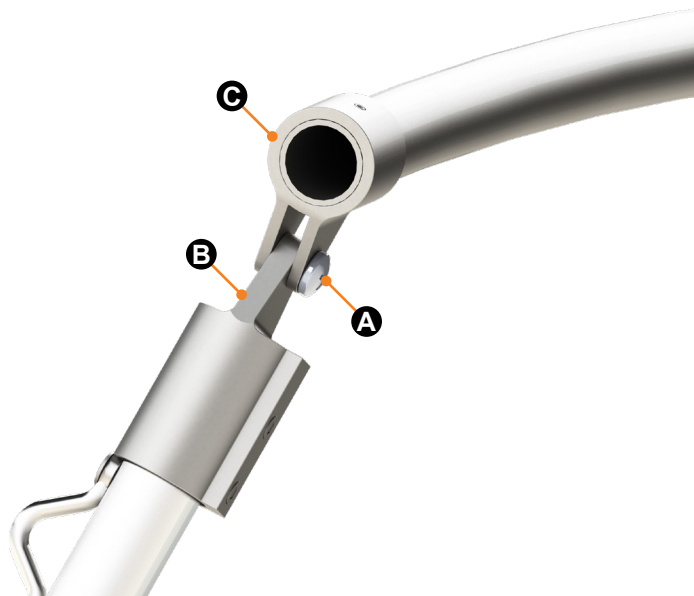

Fig.11

17. Locate the stanchions:

A. Position each swivel stud for insertion into the locking plate (Fig.12).

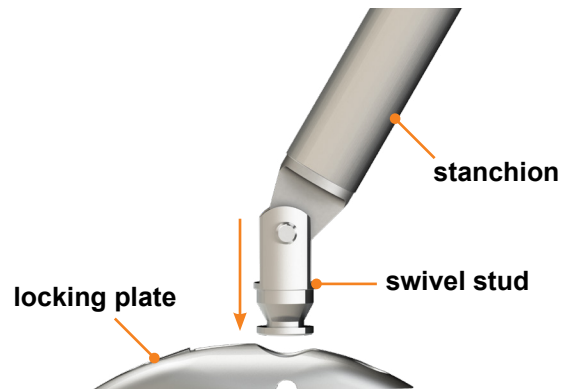

Fig.12

B. Place the locking plates (Fig.13A) as far forward on the top rails towards the front of the boat without interfering with any obstructions, e.g., doors, furniture.

C. The stanchions should be positioned at a forward angle so when the locking plates are installed a forward and downward tension will be applied to the fly extension (Fig.13).

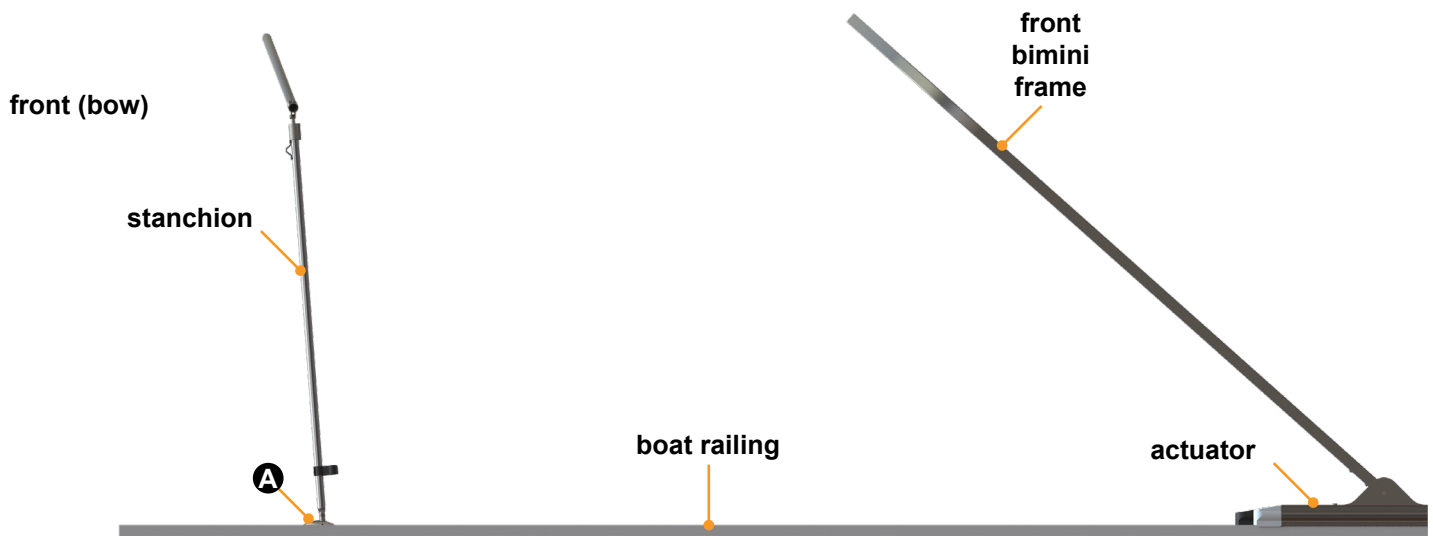

Fig.13

D. Use a tape measure and a non-permanent marker to make sure each locking plate is located the same distance, between 98"-108" from the front of the actuator body (Fig.14).

NOTE: Installing the slide base closer to 108" will provide better stretching of the fly extension's fabric and better clearance under the canopy.

E. Position the locking plates where previously located in steps B-D.

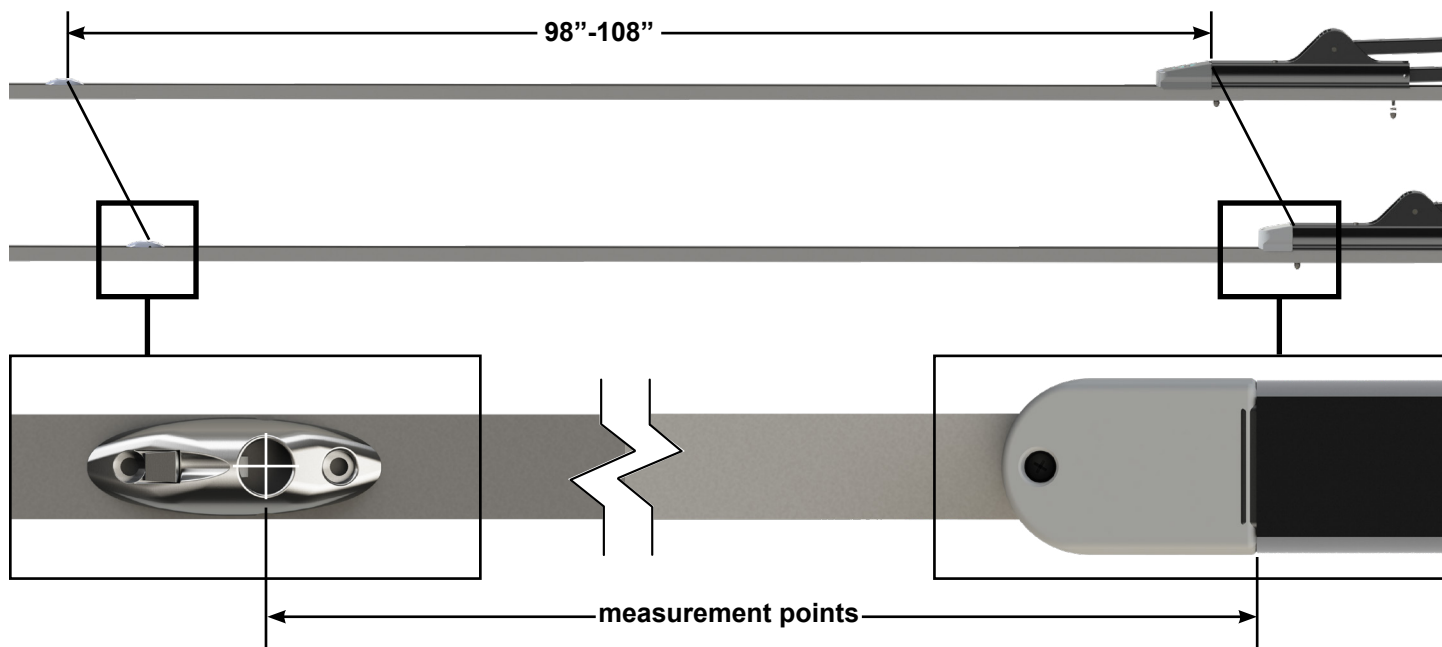

Fig.14

F. Insert two ¼"-10 x ¾" Phillips head self-drilling screws (Fig.15A) into the locking plates (Fig.15B) to attach the plates to the boat railings.

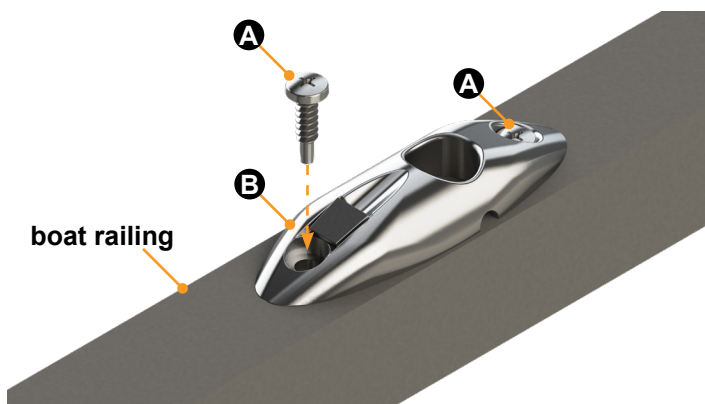

Fig.15

G. Reinsert the stanchions into their locking plates (Fig.16).

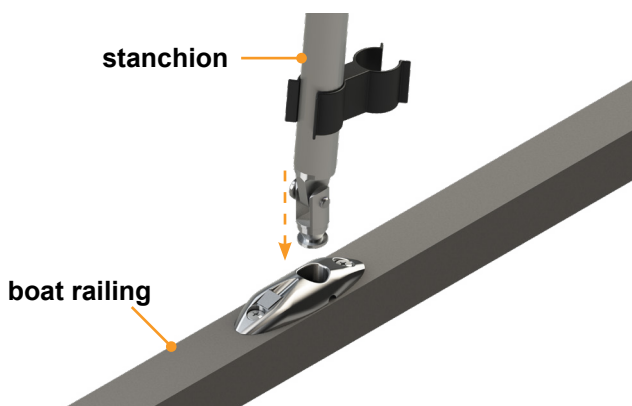

Fig.16

18. With stanchions locked in place at the front of the boat, install adjustable tie-down straps as follows:

A. If necessary, clip the adjustable buckle end of the tie-down straps to the saddle on the stanchion (Fig.17A).

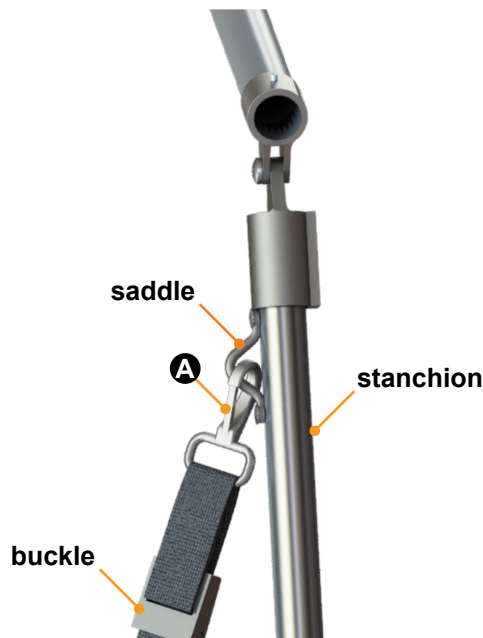

Fig.17

B. Pair the other end of the tie-down straps (Fig.18A) with loose saddles (Fig.18B) then move them towards the front of the boat. Adjust the tie-down straps for length if necessary.

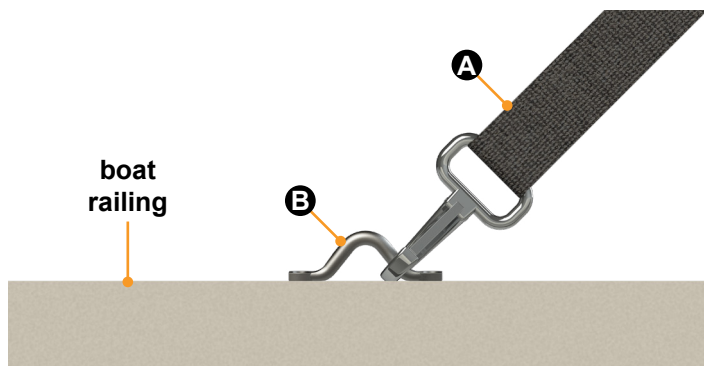

Fig.18

C. Using a non-permanent marker, mark the location of the saddles' mounting holes.

D. Separate the loose saddles from the tie-down clips (Fig.19).

E. Align the saddles' mounting holes with their previously marked (step C) locations, then install two 1/4"-10 x 3/4" Phillips head self-drilling screws (Fig.19A) to secure the saddles.

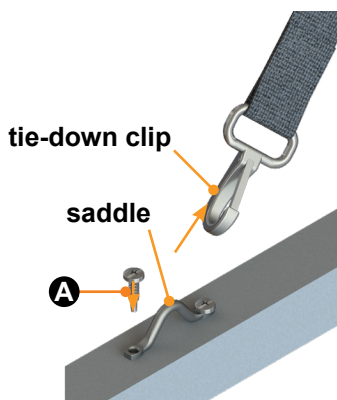

Fig.19

F. Attach the tie-down straps' clips to the saddles (Fig.18).

G. Pull downward on each tie-down's adjustment buckle until the fly extension is taut and does not sag.

Reverse (rear) Fly Extension

When using a high speed mesh top, the fly extension can also be reversed, passing underneath the mesh top, to provide additional protection from undesirable weather conditions.

While the reversed fly extension position can be obtained with any Lippert bimini top with a zippered front pocket, its true benefit is best experienced in combination with a high speed mesh top.

The installation of the reversed fly extension position is performed in the same manner as outlined for the front, except the fabric is placed underneath the bimini top and secured to the rear rails with locking plates for the stanchions and saddles for the tie-down straps.

1. With the fly extension already installed and the bimini top frame and canopy fully extended—see Front Fly Extension procedure—unfasten the adjustable tie-down straps from their front-railing saddles and release the stanchions from their front-railing locking plates.

2. Walk the stanchions to the rear of the boat, passing the fly extension underneath the extended canopy.

3. Follow steps 17 and 18 of the Front Fly Extension section to install rear locking plates and tie-down strap saddles, except as follows:

A. Place the locking plates as far rearward on the top rails towards the rear of the boat without interfering with any obstructions, e.g., doors, furniture.

B. The stanchions should be positioned at a forward angle—towards the rear of the boat—so when the locking plates are installed a forward and downward tension will be applied to the fly extension.



SureShade® Power Bimini Upgrades: Fly Extension

Installation and Owner's Manual

(For Aftermarket Applications)

Operation

⚠ CAUTION

DO NOT EXCEED 15 MPH WHEN FLY EXTENSION IS DEPLOYED. EXCEEDING MAXIMUM SPEED LIMIT WITH FLY EXTENSION DEPLOYED CAN CAUSE DAMAGE TO THE EXTENSION AND VOID PRODUCT WARRANTY.

Front Fly Extension

1. If necessary, open the bimini top to its fully-opened position.

NOTE: Do **NOT** fully open the QC bimini system without the canvas top installed or failure of the system will result.

2. Extend the fly extension forward, towards the front of the boat as follows:

A. Unzip the front storage bimini pocket and unfurl the fly extension to release the stanchions.

B. Grasp the stanchions and walk the fly extension towards the front of the boat.

C. Insert each stanchion in its respective locking plate.

D. Extend and clip each stanchion's tie-down strap onto its respective saddle.

E. Pull tie-down straps taut to ensure proper forward installation of the fly extension.

Reverse (rear) Fly Extension

With the bimini top fully opened and the fly extension mounted forward, reverse the bimini top as follows:

1. Loosen tie-down straps and unclip them from their saddles.

2. Remove the stanchions from their locking plates.

3. Grasp the stanchions and walk the fly extension towards the rear of the boat, under the opened bimini top.

4. Insert each stanchion in its respective locking plate.

5. Extend and clip each stanchion's tie-down strap onto its respective saddle.

6. Pull tie-down straps taut to ensure proper reverse installation of the fly extension.

Storage

Store the fly extension as follows:

1. Unzip the front storage bimini pocket.

2. Loosen tie-down straps and unclip them from their saddles.

3. Remove the stanchions from their locking plates.

4. Fold the stanchions and tie-down straps into the fly extension material then roll the fly extension material towards the front storage pocket of the bimini top.

5. Tuck the rolled-up material into the storage pocket and zip closed.



SureShade® Power Bimini Upgrades: Fly Extension

Installation and Owner's Manual

(For Aftermarket Applications)

Troubleshooting

What is happening?	Why?	What should be done?
Fly extension stanchions do not reach the locking plates.	Fly extension not fully extended.	Fully extend fly extension.
	Bimini top not fully extended.	Fully extend bimini top.
	Locking plates mounted too far away.	Relocate locking plates.
Stanchions do not lock in-place.	Bad locking button.	Contact Lippert. Email: customerservice@lci1.com Phone: 432-LIPPERT (432-547-7378)
Tie-down strap does not reach the saddle.	Saddle mounted too far away.	Relocate saddle.
	Tie-down strap not extended enough.	Adjust tie-down strap buckle to increase strap length.
Tie-down strap clip does not close on saddle or stanchion.	Bad spring clip.	Replace tie-down strap.

Maintenance

Fabric Care

The fly extension can be cleaned while installed on the boat or separately when removed.

NOTE: It is good practice to clean the fly extension at the same time when cleaning the bimini top.

Use clear water to consistently hose off the fly extension fabric during the boating season.

When necessary, a deeper clean of the fly extension fabric can be done as follows:

1. If necessary, remove the protective boot, fully extend the bimini top and attach the fly extension to the front of the boat.
2. If the top and extension was stored wet, allow the boot, top and extension fabric to dry.
3. Remove any loose dirt and debris from all fabric.
4. Hose down the top, extension and boot fabric with clear water.
5. Prepare a mixture of ¼ cup of mild dish soap and five gallons of warm water.

NOTE: Do **NOT** use harsh detergents.

6. Use a soft bristle brush to apply the soapy water to the fabric to remove stains and embedded dirt.

7. Allow the solution time to soak completely into the fabric.

8. Hose off the top, extension and boot fabric with fresh, clear water. Repeat rinse if necessary.

9. Allow bimini top, fly extension and boot to dry before storing the extension, closing the top and installing the protective boot.

If cleaning the fly extension separately:

- A. Unzip the extension fabric from the bimini top.
- B. Slide the extension fabric to one side of the front tube so the two sections of the tube can be separated.
- C. Completely remove the fabric from the tube.

CAUTION

DO NOT MACHINE WASH OR MACHINE DRY THE EXTENSION FABRIC OR DAMAGE TO THE FABRIC CAN RESULT. HAND WASH AND LINE DRY FABRIC ONLY.

- D. Hand-wash the fabric by following the same, previous procedure for cleaning the open bimini top and extension.

NOTE: Do **NOT** machine wash or machine dry the extension fabric. Hand wash and line dry only.

[illegible]

Installation and Owner's Manual

(For Aftermarket Applications)

[illegible]