

SLIDE-OUTS

Purpose

This document is for identifying the differences between the Standard (Fig. 1) and Inverted (Fig. 2) gear racks of an In-wall Slide-out system. There are specific repair kits available for the Standard and Inverted gear rack systems.

Fig. 1

Standard Gear Rack

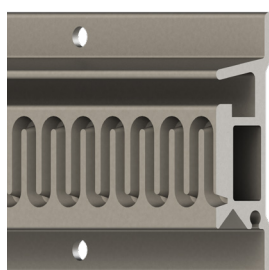

Upper Rack

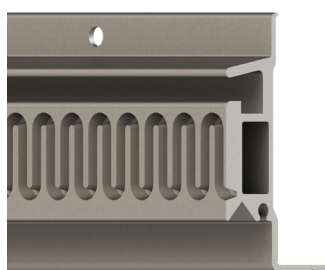

Lower Rack

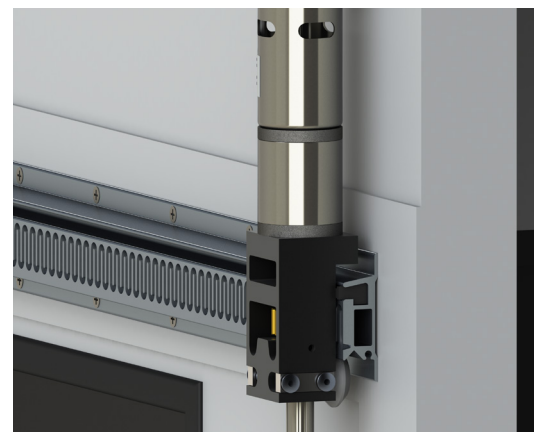
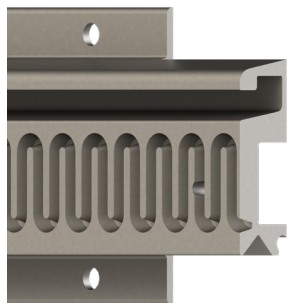
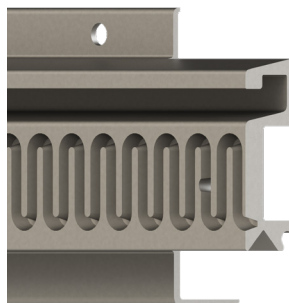

Fig. 2

Inverted Gear Rack



Upper Rack



Lower Rack

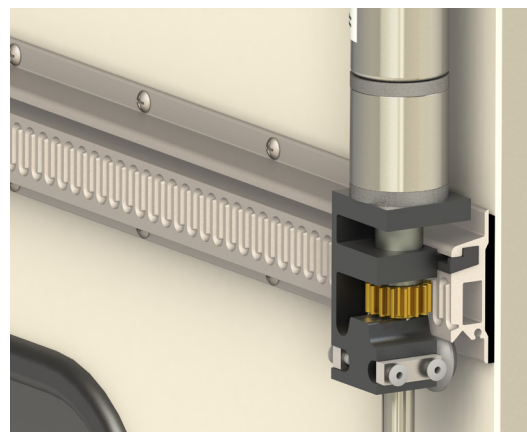

NOTE: The assembly images on the right in Figures 1 and 2 are cut-out for clarity. The installed system will not have the same view.

SLIDE-OUTS

Repair Kits Part Numbers

Standard (w/ 1.56" Notch)

Fig. 3 - 1.56" Notch

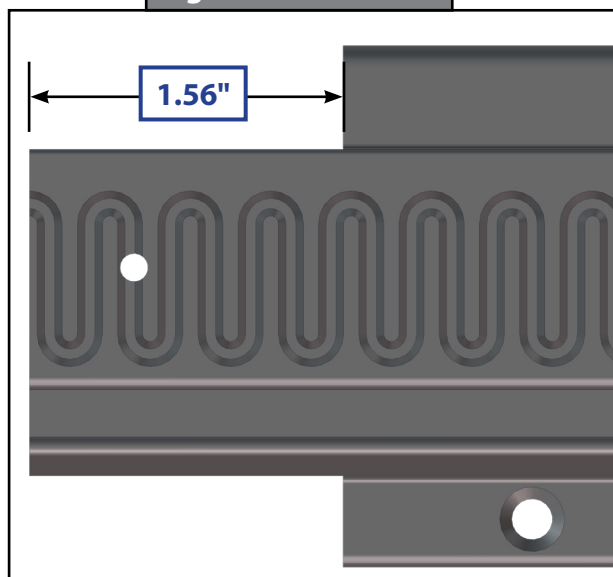

Repair Kit Part Numbers		
Clear Part #	Black Part #	Description
366154	366209	Standard Fixed Repair Kit
366156	366211	Standard Float Repair Kit
366158	366212	Inverted Fixed Repair Kit
366159	366213	Inverted Float Repair Kit
366160	366214	Triple Fixed Repair Kit
366161	366215	Triple Float Repair Kit

Bearing Block Repair Kit

If the bearing blocks need to be replaced, a repair kit that includes one upper and one lower bearing block, four plastic rivets, and two aluminum rivets is available. Part numbers are on the table below.

NOTE: Triple Bearing Block kit will include one upper and two lower bearing blocks, six plastic rivets, and three aluminum rivets.

Bearing Block Repair Kit Numbers	
Kit #	Description
379060	Standard Bearing Block Repair Kit
379076	Inverted Bearing Block Repair Kit
379077	Narrow Bearing Block w/ Composite Gibs Repair Kit
379720	Triple Bearing Block Repair Kit

SLIDE-OUTS

Custom

If the system being repaired has a different notch than the 1.56" described in Figure 3, use the images below to identify the notch, then contact Lippert at (432) 547-7378 for ordering assistance.

NOTE: If the gear rack being replaced has notches on both ends, the rack will need to be custom ordered. Contact Lippert at (432) 547-7378 for ordering assistance.

Custom Kit Numbers	
Kit #	Description
366121	Standard (without gear racks)
366120	Inverted (without gear racks)
366106	Triple (without gear racks)

Fig. 4 - 1.0" Gutter Notch

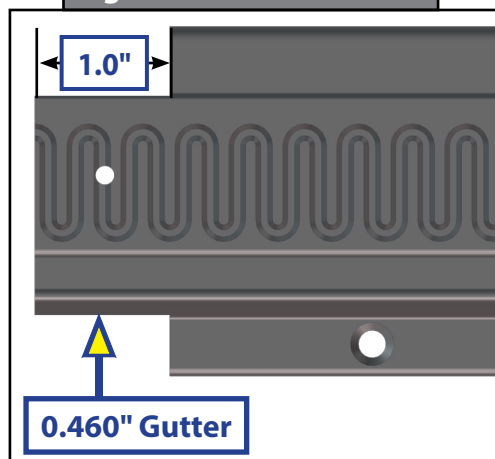

Fig. 5 - 1.0" Notch

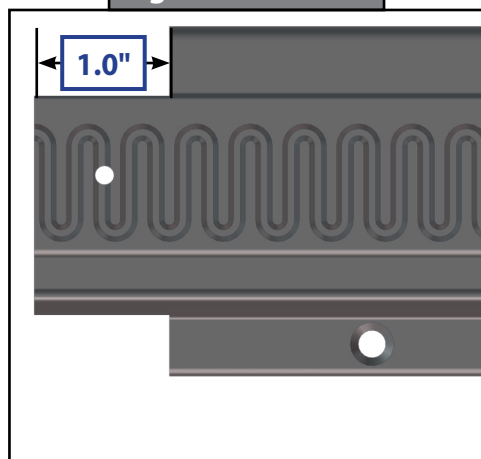

Fig. 6 - 1.75" Notch

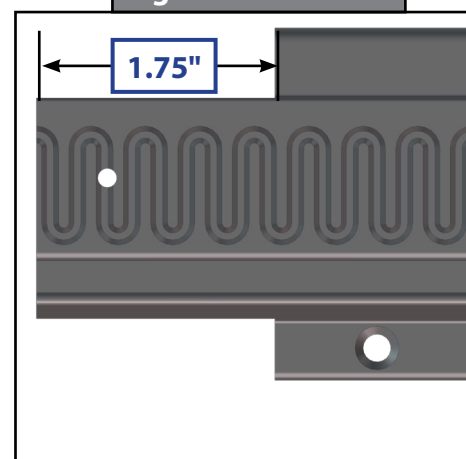

Fig. 7 - 2.0625" Notch

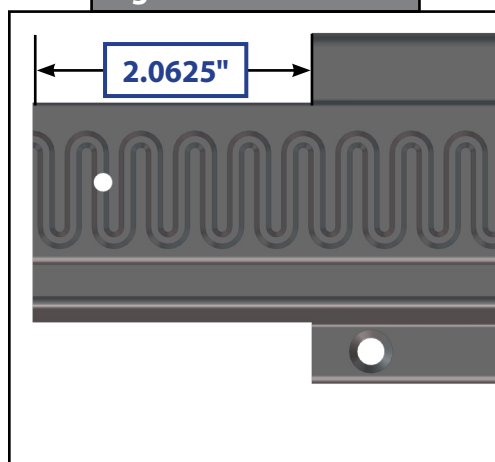
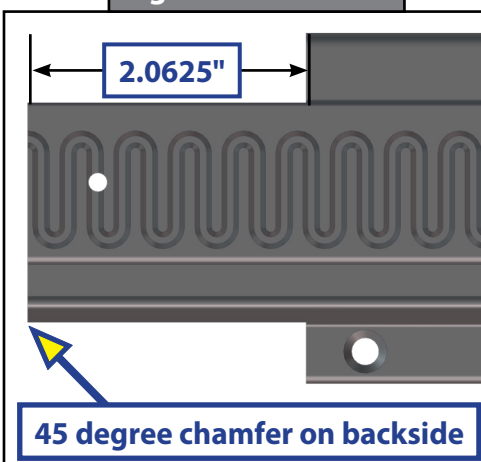
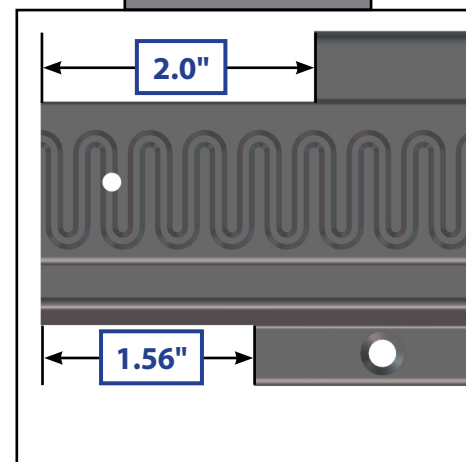

Fig. 8 - Tiffin Notch



Pinnacle Notch



As a supplier of components to the RV industry, safety, education and customer satisfaction are our primary concerns. Should you have any questions, please do not hesitate to contact us at 432-LIPPERT (432-547-7378) or by email at customerservice@lci1.com. Self-help tips, technical documents, product videos and a training class schedule are available at lippert.com or by downloading the LippertNOW app.