

INSTALLATION MANUAL

GGG23M

Level of Difficulty

Easy

Installation difficulty levels are based on time and effort involved and may vary depending on the installer level of expertise, condition of the vehicle and proper tools and equipment.

Parts List

Qty	Description
1	Driver-side mounting bracket
1	Passenger-side mounting bracket
1	Grill insert 2
4	Carriage bolt, 1/2"-13 x 1-1/2"
4	Hex lock nut, 1/2"-13
4	Flat washer, 1/2"
9	Button head bolt, 1/4"-20 x 3/4"
9	Keyp nut, 1/4"-20
1	Grill guard

Tools Required

Ratchet	Torque wrench
Allen wrench, 5/32"	Socket extension
SAE socket set	SAE wrenches
Metric socket set	Metric wrenches

Torque Specifications

M12 bolt	59 ft-lbs.
1/2" bolt	75 ft-lbs.

Product Photo



NOTICE

Visit www.ranchhand.com for a full-color copy of this instruction manual, as well as helpful videos, guides and much more!

Before you begin installation, read all instructions thoroughly.

Proper tools will improve the quality of installation and reduce the time required.

Periodic inspection of your product should be performed to ensure all hardware and / or components remain secure.

To help prevent damage to the product or vehicle, refer to the specified torque specifications when securing hardware during the installation process.

Maintenance

Mild automotive detergent may be used to clean the product. Do not use dish detergent, abrasive cleaners, abrasive pads, wire brushes or other similar products that may damage the finish.

Product Registration and Warranty

Ranch Hand stands behind our products with industry-leading warranties. To get copies of the product warranties, register your purchase or provide feedback, visit: warranty.curtgroup.com/surveys

Step 1

Remove the plastic skid plate. There will be five 13mm bolts. Remove the bolts.



Step 2

Remove the tow hook and shield around the tow hooks. There will be two 18mm bolts and nuts for each tow hook.



Step 3

Install the bottom brackets by reusing the factory tow hook bolts. The exposed bracket that mounts to the grill guard will be to the outside of the frame.

Step 4

Pull the brackets to its lowest point where the bracket is bottomed out on the tow hook bolts and pull the brackets forwards away from the bracket then tighten bolts.

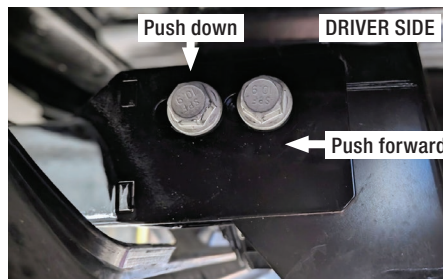

Step 5

Reinstall the skid plate.

Step 6

Mount the grill guard by using four (4) 1/2" carriage bolts, washers, and nuts. Level the grill guard and tighten the nuts.

Step 7

If your truck does not have a front camera, install the center insert. Use nine (9) 1/4" button head bolts and kep nuts to install.