

## KITCHEN AND BATH

### Purpose

This document outlines the procedure of replacing the cartridge in the Flow Max Faucets.

### Safety

#### **WARNING**

The “WARNING” symbol above is a sign that a procedure has a safety risk involved and may cause death or serious personal injury if not performed safely and within the parameters set forth in this manual. Always wear eye protection when performing this installation procedure. Other safety equipment to consider would be hearing protection, gloves, and possibly a full face shield, depending on the nature of the installation procedure.

#### **CAUTION**

The “CAUTION” symbol above is a sign that a safety risk is involved and may cause personal injury and/or product or property damage if not safely adhered to and within the parameters set forth in this manual.

#### **CAUTION**

Moving parts can pinch, crush or cut. Keep clear and use caution.

### Required Resources

- 2.5 mm hex wrenches
- Needle nose pliers
- Adjustable wrench
- Safety glasses

### Prior to Replacement

1. Shut off the hot and cold water outlet supply valves for the existing faucet, typically located below the sink.
2. Relieve any pressure from the existing faucet by turning the existing faucet on and off.

# FLOW MAX™ FAUCET CARTRIDGE REPLACEMENT

## KITCHEN AND BATH

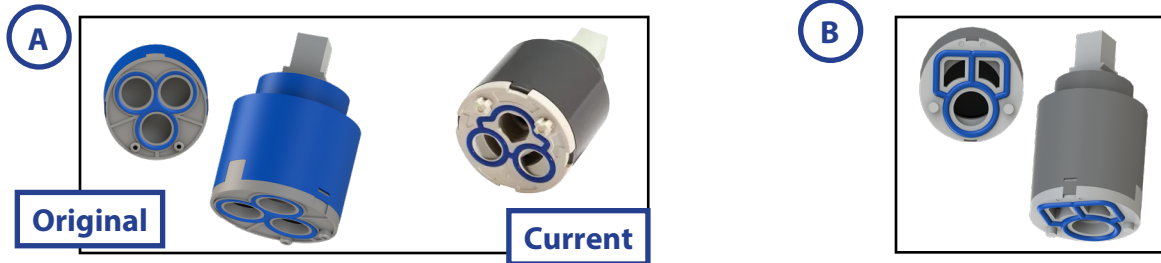

Call Out	Part #	Description
A	<a href="#">2021025928</a>	Cartridge A (Shown are Original and Current Cartridge)
B	<a href="#">2021025929</a>	Cartridge B



Call Out	Part #	Description	Cartridge Used
A	<a href="#">692179</a>	Luminary Lavatory Faucet	A
B	808232	Black Matte Kitchen Pull Down Faucet	B
C	808235	SS Kitchen Pull Down Faucet	B
D	787509	Black Kitchen Faucet	A
E	<a href="#">719324</a>	Curved Gooseneck Fixed Installation	A
F	<a href="#">719325</a>	Squared Gooseneck Fixed Installation	A
G	<a href="#">719333</a>	Bullet Pull Down Installation	A
H	<a href="#">719323</a>	Coiled Spring Sprayer Faucet	A
I	729395	Swan Pull Down Faucet <b>(OBSOLETE)</b>	A
J	696320	Black Hose Kitchen Faucet <b>(OBSOLETE)</b>	A
K	729396	Waterfall Bathroom Faucet	A
L	2022110112	Black Matte Square Bathroom Faucet	A
M	2022110113	SS Square Bathroom Faucet	A
N	2024000068	Square Gooseneck Faucet - Satin Bronze	A
O	<a href="#">2024000071</a>	Bullet Pulldown Faucet - Black Matte/Satin Bronze	A

## Replacement

1. Locate the set screw on the faucet model. Depending on faucet model the set screw is located in three different locations.
  - A. Under the lever handle (Fig. 1): Remove lever handle by turning clockwise to access set screw.
  - B. Under the rubber plug on the faucet handle (Fig. 2): Remove rubber plug to access set screw.
  - C. Under the faucet handle (Fig. 3): Turn faucet to "ON" position to access set screw.

Fig. 1

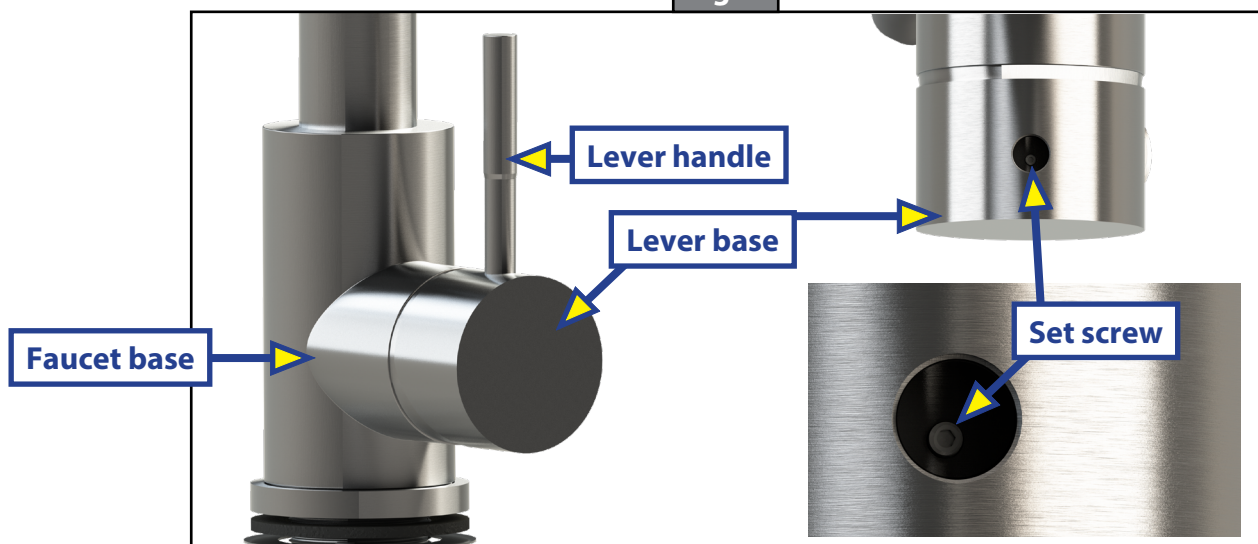

Fig. 2

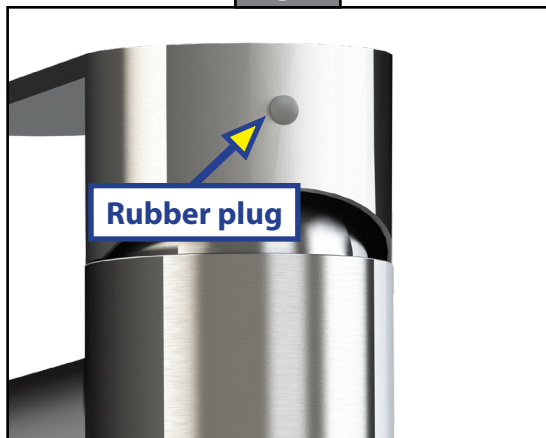
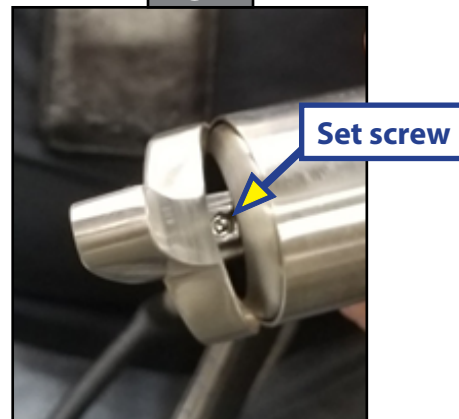

Fig. 3



## KITCHEN AND BATH

2. Using the 2.5 mm hex wrench, loosen the set screw and remove the lever base found on each model (Fig. 4).

**NOTE:** It is not necessary to completely remove the set screw.

Fig. 4



3. Depending on faucet model there are two styles of trim rings that need to be removed.

- A. Unscrew by hand from cartridge retainer ring (Fig. 5).
- B. Place finger under trim ring (Fig. 6A) and pull out of faucet base (Fig. 6).

Fig. 5



Fig. 6

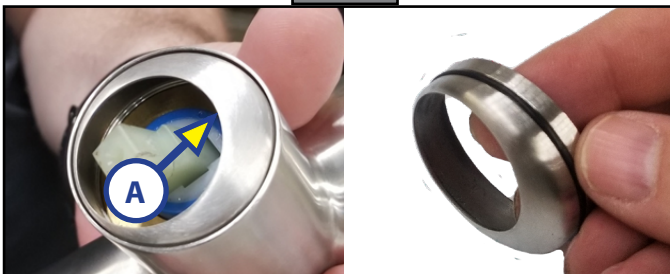

4. Remove the retainer ring that holds the cartridge in place (Fig. 7).

- A. Flat-sided (Fig. 7A): Use pliers or adjustable wrench to grip and unscrew from faucet base.
- B. Spanner style (Fig. 7B): Open needle nose pliers and place each end in recessed spanner hole and unscrew.
- C. Tab style (Fig. 7C): Open needle nose pliers and place each end on opposite sides of tabs and unscrew.

Fig. 7

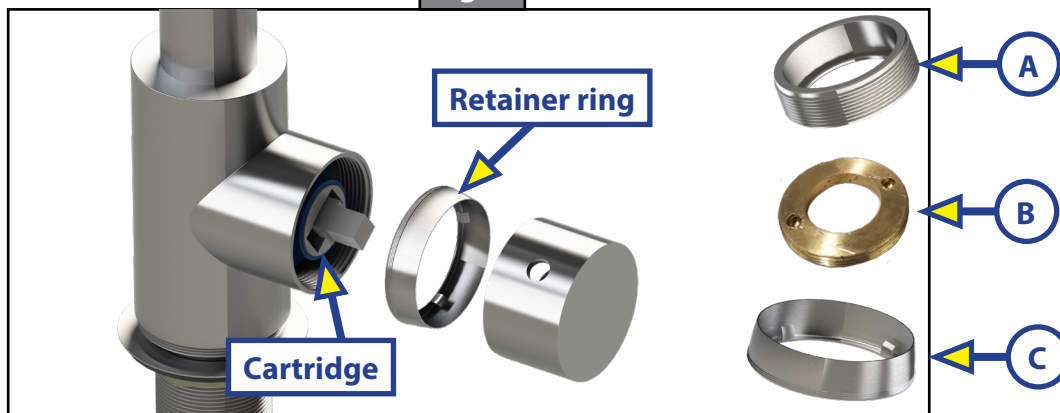

## KITCHEN AND BATH

5. Remove the cartridge (Fig. 8) by pulling it away from the faucet base.

**NOTE:** Depending on faucet model, there are two different styles of cartridges

Fig. 8



## Cartridge Installation

**NOTE:** Before installing the cartridge, remove any debris or build-up by wiping the installation area clean (Fig. 10).

1. Line up the pilot studs (Fig. 9A) on the bottom of the new cartridge with the indentations on the inside of the faucet base (Fig. 10A) and insert the new cartridge.

**NOTE:** If cartridge is not lined up correctly it will restrict water flow.

Fig. 9

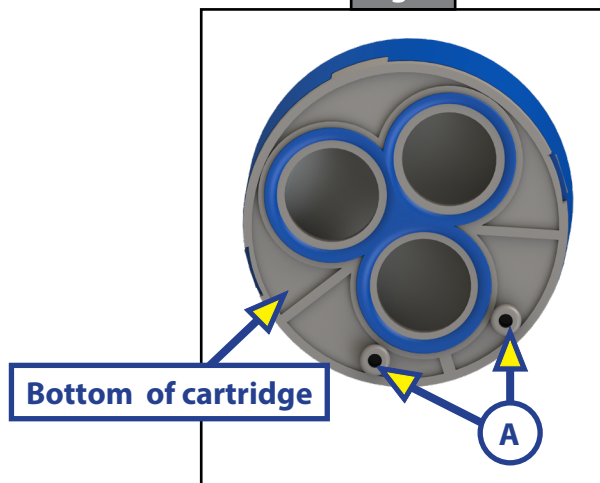
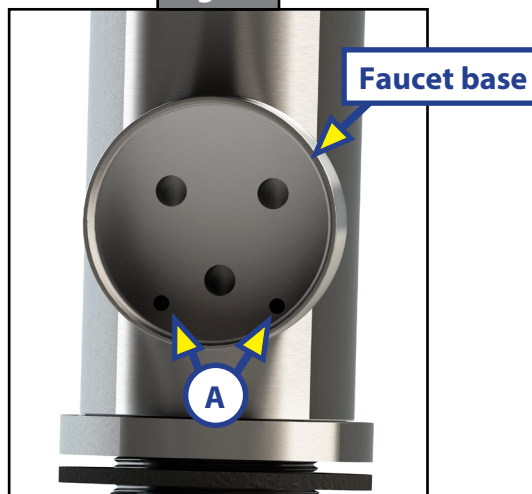

Fig. 10





## KITCHEN AND BATH

2. Replace retainer ring over the cartridge into the faucet base.
  - A. Flat-sided style: Place washer into the lever base, tighten with pliers or adjustable wrench.
  - B. Spanner style: Open needle nose pliers and place each end in recessed spanner hole and screw in.
  - C. Tab style: Open needle nose pliers and place each end on opposite sides of tabs and screw in.
3. Replace the trim ring (Fig. 11).
  - A. Tighten by hand.
  - B. Press into place until the trim ring is securely seated in the faucet base.

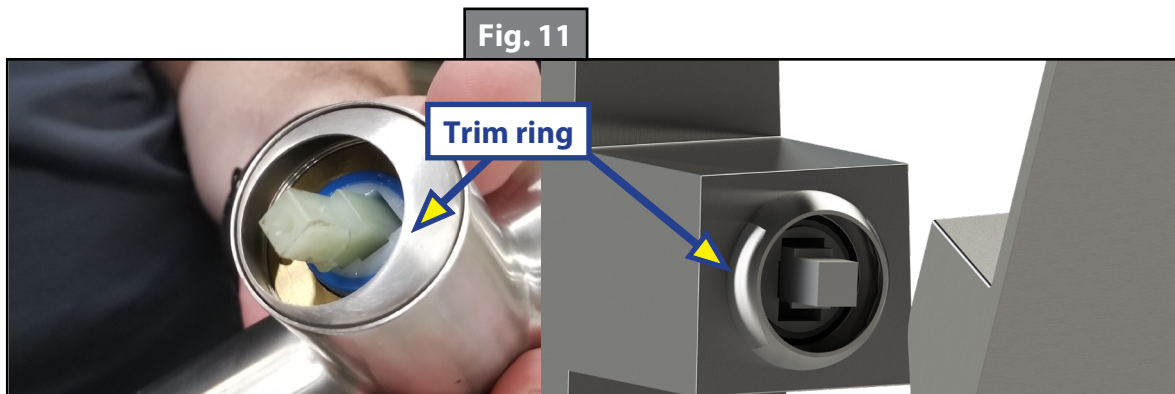

4. Replace lever base (Fig. 12) and tighten the set screw with the 2.5 mm hex wrench.
5. Replace lever handle, thread back onto lever base if faucet model requires it (Fig.13).

