

WINDOWS

Purpose

This document shows the tools and steps required to perform a window operator replacement on a 3000 Series RV window. As of 9-21-2021, all 7" and 9.5" window operators were consolidated to the 4" operator. New windows will be pre-fitted with 4" operators, but field replacements will utilize the part number given below to replace both the 7" and 9.5" operators as needed.

Part number	Description
236886	RM03005-4-03; 3000- OPERATOR 4" BLK

Resources Required

- Cordless or electric drill or screw gun
- $\frac{3}{16}$ " drill bit
- Rivet gun

Procedure

⚠ CAUTION

Moving parts can pinch, crush or cut. Keep clear and use caution.

1. Remove the screen and open the window slightly.
2. Use a $\frac{3}{16}$ " drill bit to drill out the rivets securing the window operator to the window frame (Fig. 1).
3. Lift the operator assembly up over the frame of the window and push the window out.
4. Remove the operator assembly by sliding the wheels out of the rail channel (Fig. 2), then remove and discard any spacers used for 7" and 9.5" operator assemblies. The spacers will not be utilized with the 4" replacement.
5. Insert the replacement operator assembly wheels into the rail channel and slide the assembly along the rail to the proper location.
6. Use a rivet gun to secure the replacement operator to the window frame with rivets (Fig. 3).
7. Reinstall the screen, making sure it snaps back into place.

Fig. 1

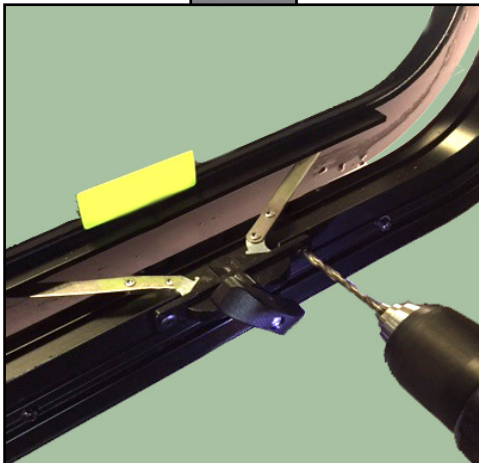
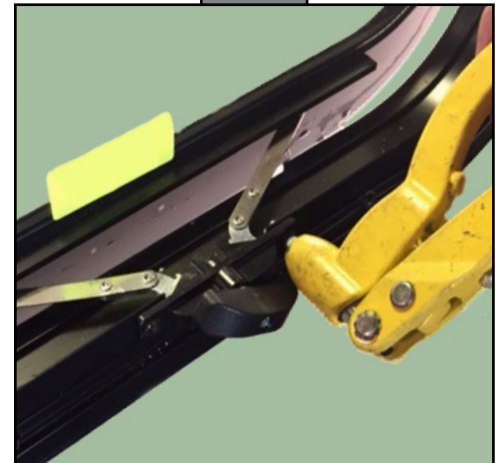

Fig. 2



Fig. 3



As a supplier of components to the RV industry, safety, education and customer satisfaction are our primary concerns. Should you have any questions, please do not hesitate to contact us at 432-LIPPERT (432-547-7378) or by email at customerservice@lci1.com. Self-help tips, technical documents, product videos and a training class schedule are available at lippert.com or by downloading the LippertNOW app.